



EDGE

SINGLE MONITOR ARM

DYNAMIC HEIGHT ADJUSTMENT

- Height Adjustment Range: 13"
 - LOW: 7" | HIGH: 20"
- Monitor Extension: 22.5"
- Monitor Retraction: 3"
- Monitor Tilt: +90°/-25°
- Monitor Rotation: +90°/-90°
- Weight Capacity (per arm):
 - Minimum: 6.5 lbs
 - Maximum: 17.6 lbs
- 180° Lock-Out Feature
- Quick Release
- Desk clamp & grommet mount included
- Benching system mount(s) available. Call for details.

MODEL #

☐ **EDGE-SLV**
☒ **EDGE-BLK** **LT**
☐ **EDGE-WHT** **LT**

LT=CALL FOR ON HAND AVAILABILITY



Monitor Quick Release

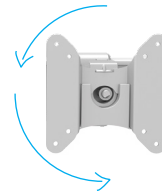

Landscape/Portrait Rotation



Cable Management



Grommet Mount



Desk Clamp

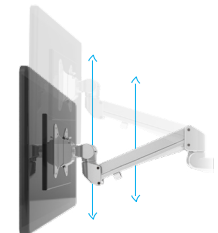

Effortless Adjustment



Integrated Allen Wrench Storage

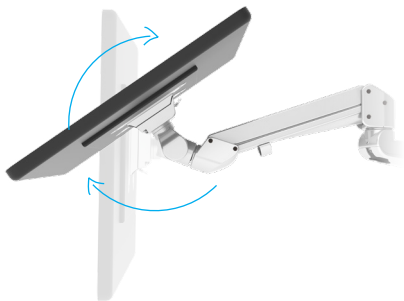
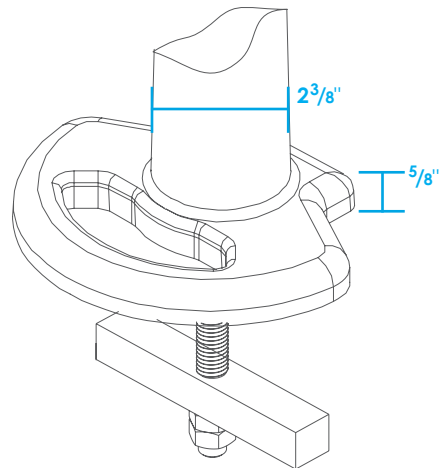
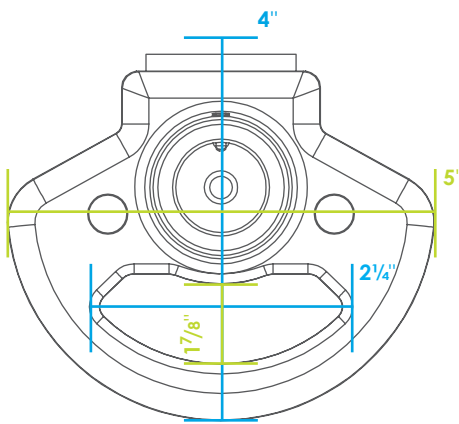
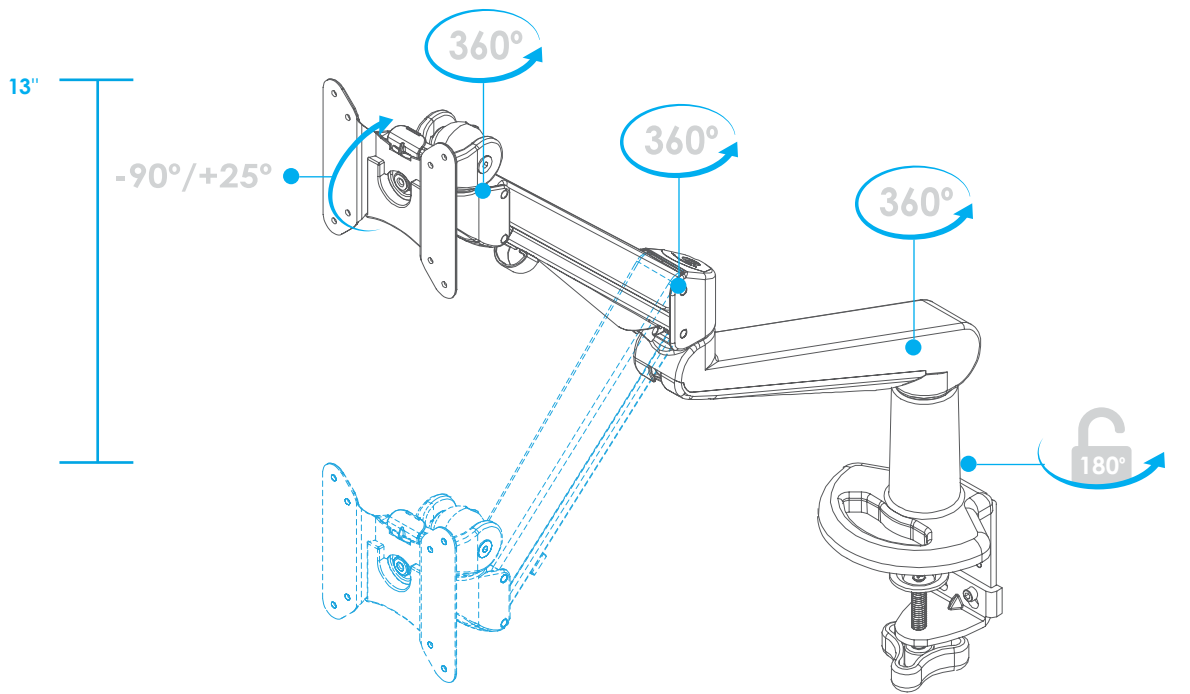

Vesa mounts tilt up and down, providing a flat writing surface for touch screen monitors.

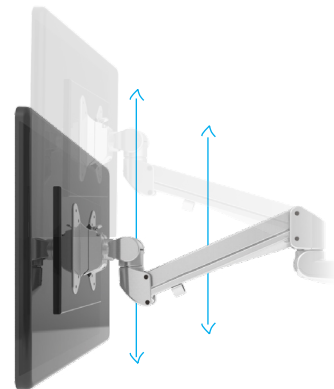

Motion arms move your monitor straight up and down.