

## WOW

Workstation On Wheels

Model WOW

WOW Rev A 11/17



# ASSEMBLY AND OPERATION

**PLEASE REVIEW** these instructions before beginning the assembly procedures. Check that all the parts and tools listed below were provided with your order. Contact your supplier if any materials are missing. Do not discard the packaging until content that the product operates to your satisfaction.

### PARTS AND TOOLS PROVIDED

	<b>VESA Screw (4)</b>  M4x10 Phillips Pan Head	<b>Screw (4)</b>  M4x11 Phillips Flat Head	<b>Nut (4)</b>  M4	<b>Washer (2)</b>  M20
	<b>Allen Keys</b> 3mm (1) 4mm (2)			
	<b>Screw (8)</b>  M6x15 Phillips Truss Head			
	<b>Bolt (4)</b>  M6x15 Phillips Hex Head	<b>Lock Washer (8)</b>  M6	<b>Washer (4)</b>  M6	<b>Nut (4)</b>  M6
<b>Cable Ties (5)</b> 				
<b>Cable Sleeve (1)</b> 				

### ADDITIONAL TOOLS REQUIRED

- #2 and #3 Phillips screwdrivers
- 14mm wrench

**STEP 1: Attach Casters to Base**

- Push casters into the holes at the end of each of the five legs. They snap securely in place.
- Do not install the two locking casters next to one another.

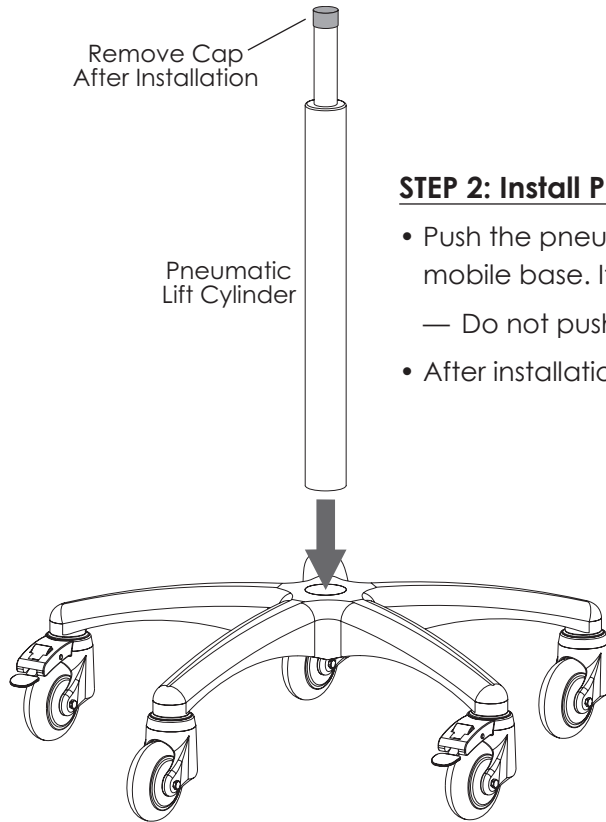
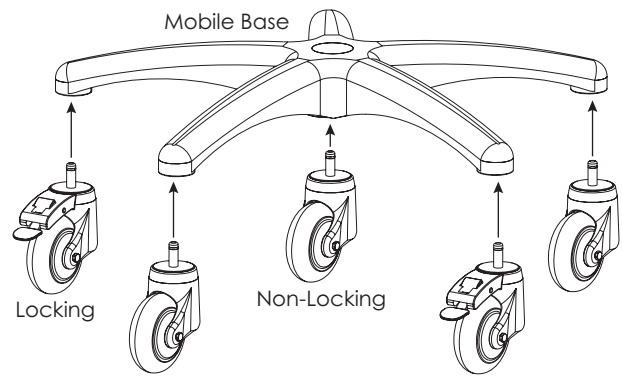
**STEP 2: Install Pneumatic Lift Cylinder**

- Push the pneumatic lift cylinder into the hole in the center of the mobile base. It snaps securely in place.
- Do not push down on the top of the cylinder.
- After installation, remove the cap from the top of the cylinder.

**STEP 3: Attach CPU Holder**

- Position the CPU holder on top of the base and attach it to the pneumatic lift cylinder using the bracket and fasteners as illustrated.
- Tighten the bolts and nuts securely. The height and orientation of the CPU holder may be changed later by loosening the bolts.

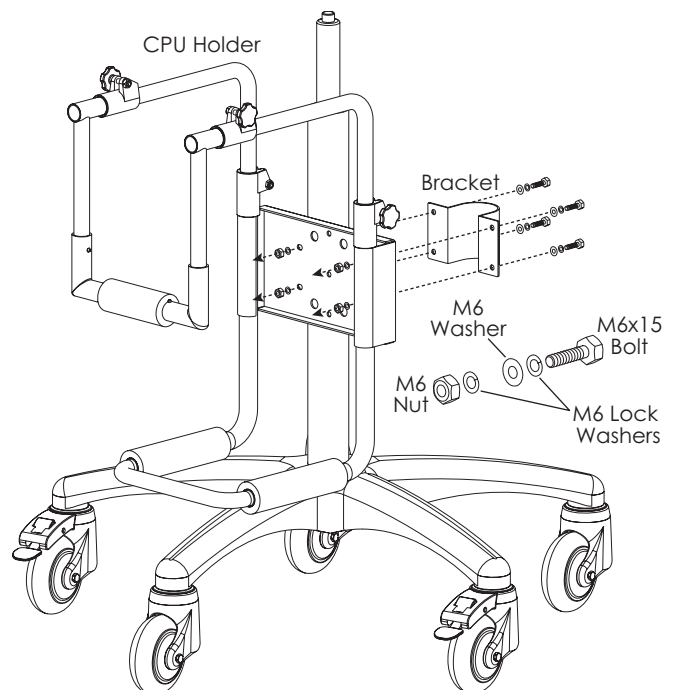

#### STEP 4: Attach Wire Controller and Bracket to Platform

- Attach the wire controller and bracket to the bottom of the platform using the 8 M6x15 Phillips truss head screws.
  - The screws fit into threaded holes on the bottom of the platform.
  - The wire controller may be attached on either side of the platform depending on which side the user wants the pneumatic cylinder control lever.
- Note the location of the two set screws on each side of the bracket mounting hole. You will need to tighten these screws after installing the platform on the cylinder.

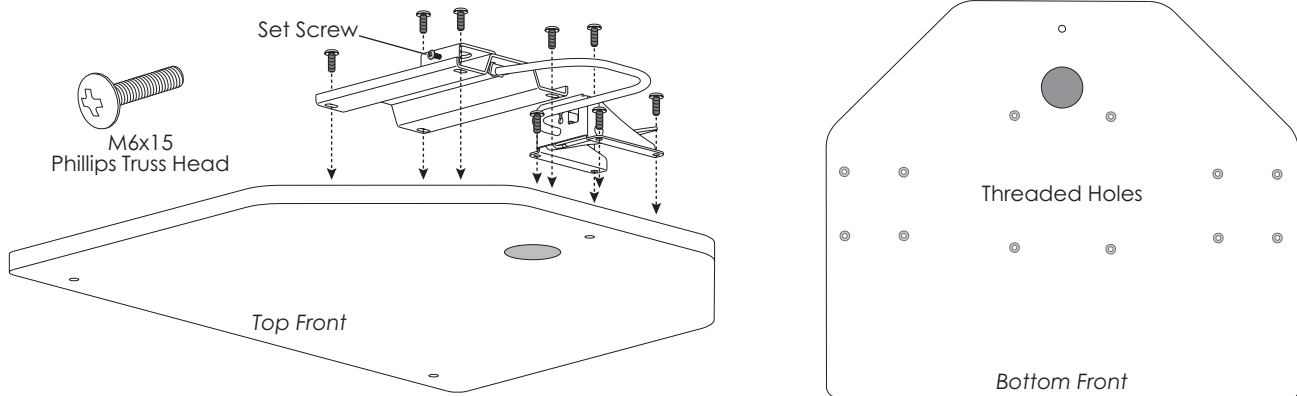

#### STEP 5: Install Platform on Pneumatic Lift Cylinder

- Push the platform onto the top part of the pneumatic lift cylinder.
  - Do not push it down so far that it presses down on the white button that activates the lift cylinder.
- While holding the platform with both hands, test operation by squeezing up the control lever.
  - This should activate the lift cylinder, allowing the platform to raise easily and be pushed down.
  - When the lever is released, the platform should hold its position.
- When operation is satisfactory, tighten the two set screws on each side of the bracket mounting hole to secure the platform in place.
- Install the palm rest by snapping it into the two holes on top of the platform.

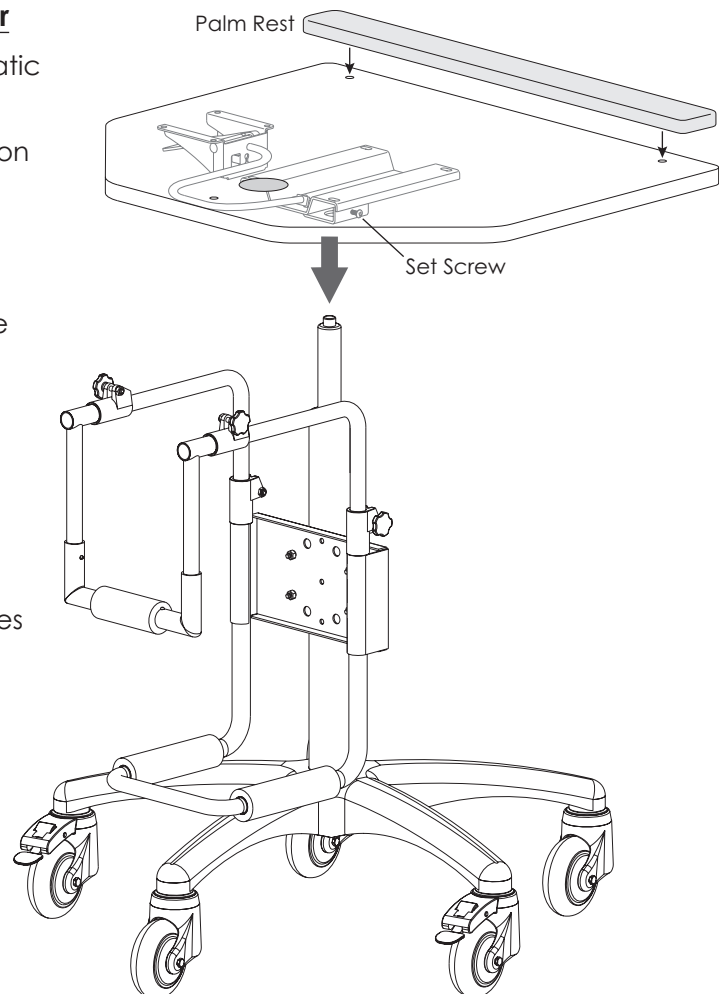

### STEP 6: Install Grommet Mount and Monitor Stand

- Remove the washer and nut from the grommet mount bolt.
- Hold the bolt in place inside the grommet mount and push the bolt through the hole at the rear of the platform.
- Place the washer over the bolt and tighten the nut to secure the grommet mount.
  - Tighten the nut using a 14mm wrench.
- Insert the monitor stand into the grommet mount.
  - Rotate the monitor stand so that the groove faces the rear. This allows the 180° lockout feature to prevent monitor rotation to the back of the WOW assembly.
  - Securely tighten the two set screws using the 3mm Allen key.

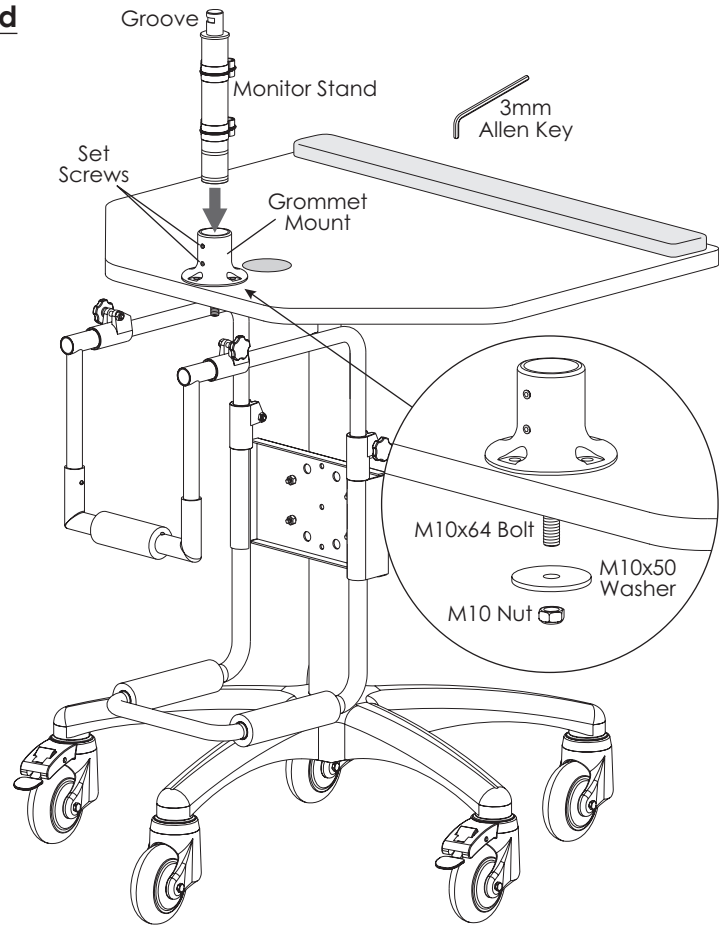

### STEP 7: Attach Monitor to Monitor Mount

- **If the monitor holes are 3" (75mm) apart:** Attach the monitor mount directly to the monitor using the M4x10 pan head screws.
  - The VESA adapter plate, M4x11 flat head screws, and M4 nuts are not used.
- **If the monitor holes are 3.9" (100mm) apart:** Attach the VESA adapter plate to the monitor mount and then attach the adapter plate to the monitor.
  - Use the M4x11 flat head screws and M4 nuts to attach the VESA adapter plate to the monitor mount.
  - The flat head screws fit through the countersunk holes on the monitor side of the adapter plate.
  - Attach the adapter plate to the monitor using the M4x10 pan head screws.

#### Holes 3" (75mm) Apart

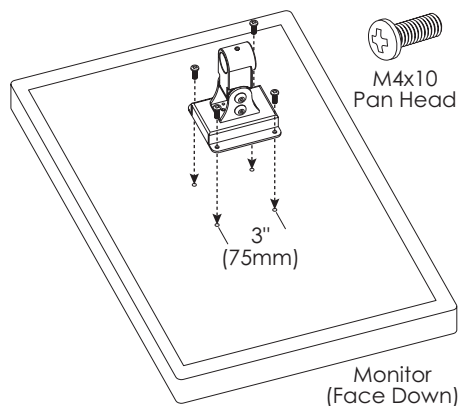

#### Holes 3.9" (100mm) Apart

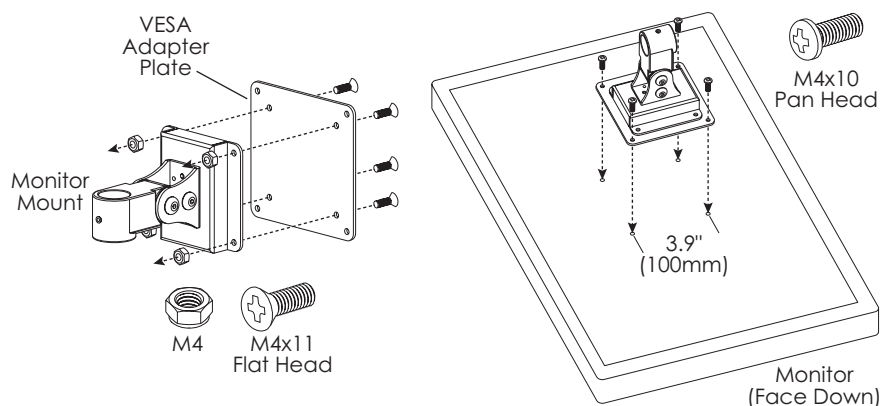

### STEP 8: Install Monitor Mount onto Monitor Stand

- Fit the monitor mount onto the top of the monitor stand.
  - See “Adjustment” on the next page if you need to tilt the mount to install it.
- Tighten the 180° lockout set screw on the monitor mount using the 3mm Allen key.
  - The screw fits into the groove on the monitor stand. It secures the mount to the stand, prevents the monitor from rotating more than 180°, and controls the ease of monitor rotation.
- Route the monitor cable and power cord through the cord clips on the monitor stand, and then down through the cable grommet hole on the platform.

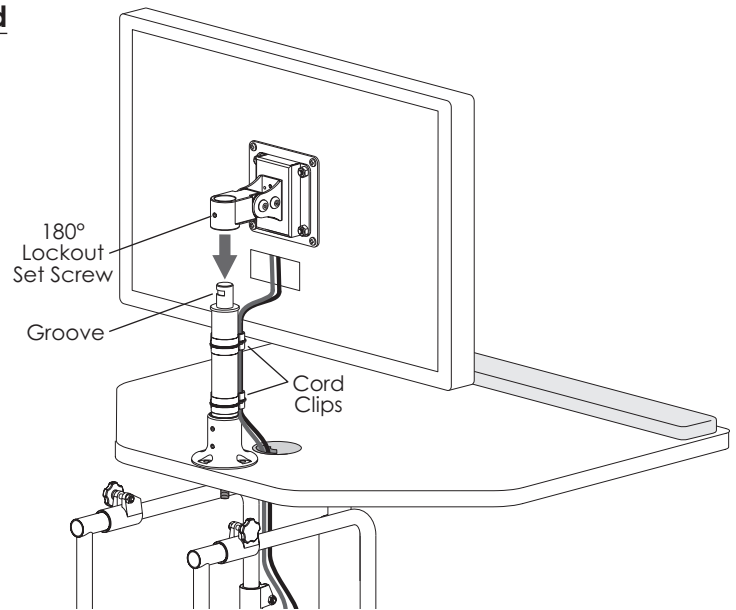

### STEP 9: Install CPU into Holder

- Loosen the knobs on the outer bracket to remove it from the CPU holder.
- Place the CPU on the pads on the bottom of the holder.
- Fit the outer bracket back onto the CPU holder. Adjust the width to fit the CPU, then tighten the knob to secure the bottom bracket in place.

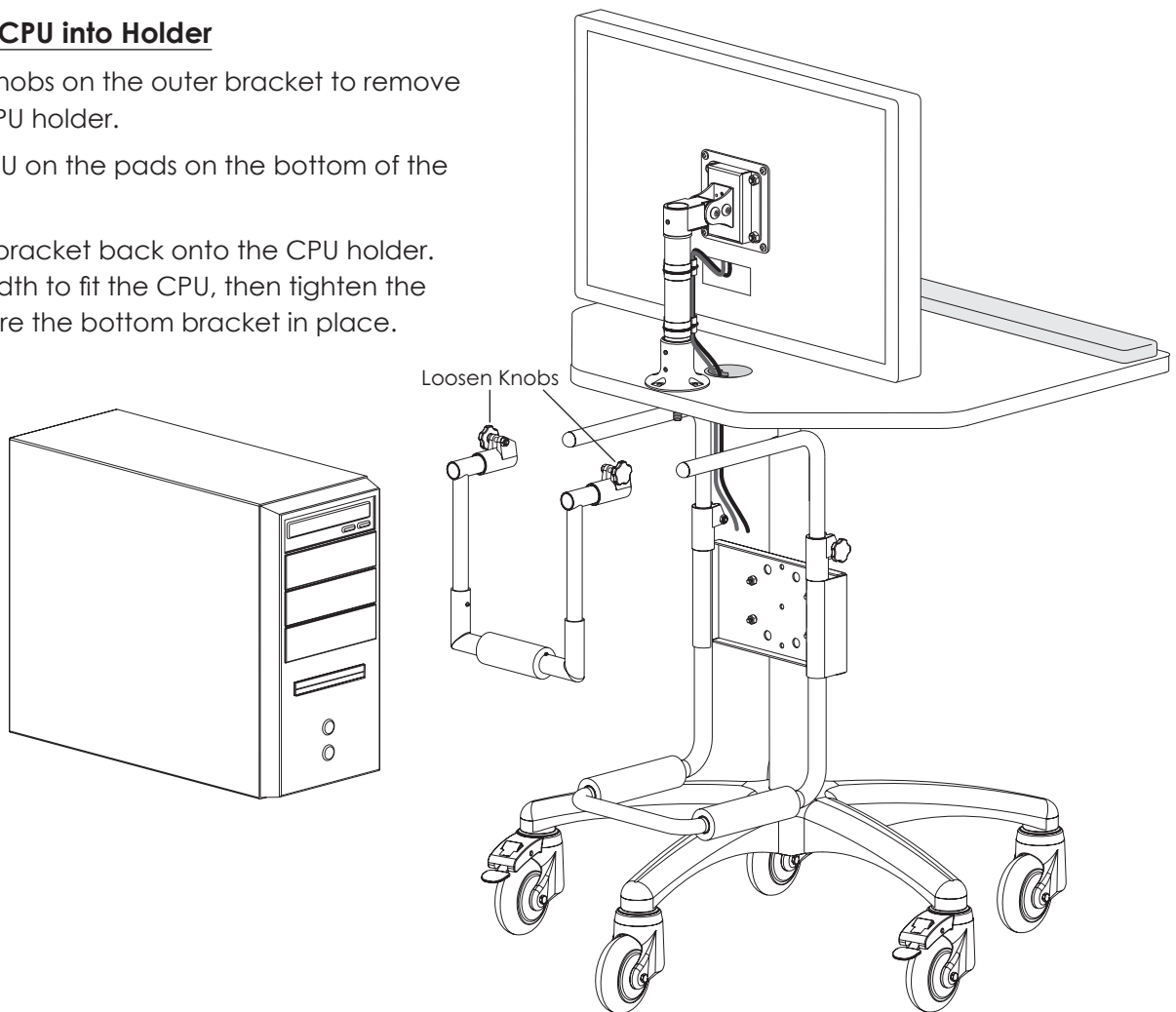

### STEP 10: Organize Cables and Cords

- Use the cable ties and/or cable sleeve to organize the cables and cords as desired.

### Operation

- Squeeze the control lever to activate the lift cylinder, allowing the platform to be raised and lowered easily.
- Release the lever to hold the platform in its current position.

### Adjustment

- To adjust monitor tilt, loosen the two sets of socket head screw.
  - Two 4mm Allen keys are provided: one to loosen the screw, the other to prevent the screw head on the other side from turning.
  - Loosen both sets of screws. Spring force prevents the monitor from tilting too far.
- Tighten the screws after completing the adjustment.

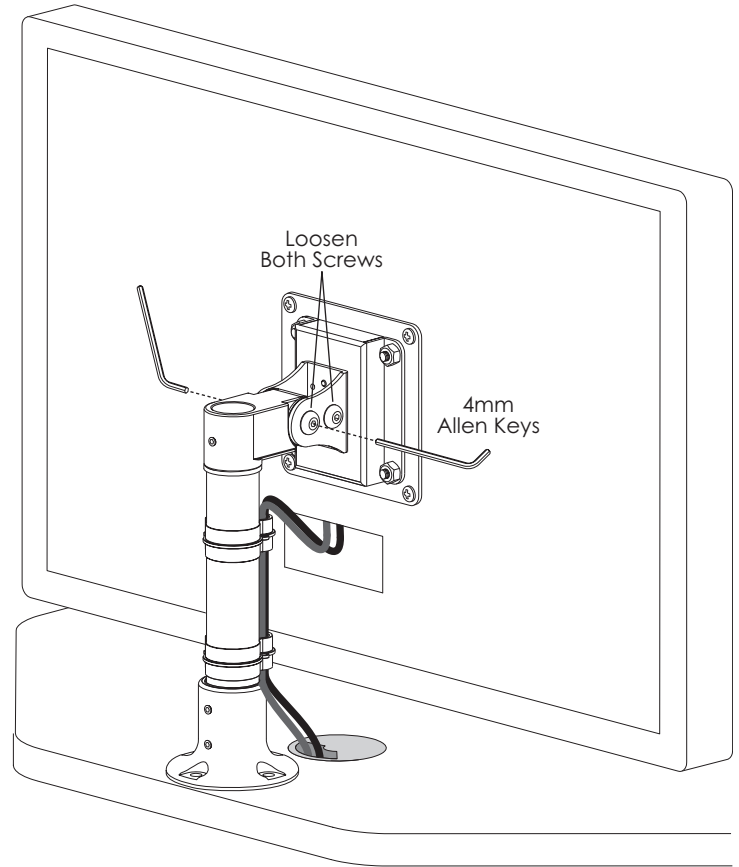



800.833.3746 | [esiergo.com](http://esiergo.com)