

## SPACER KIT

### GLIDE TRACK ACCESSORY

Ideal for Height adjustable tables and Benching systems, the Spacer-Kit creates a flat mounting surface for keyboard arms and glide tracks where cross channels typically prevent installations.

- Compatible with most ESI keyboard arms and glide tracks\*
- Attaches between underside of work surface and a keyboard arm or glide track
- Includes mounts for benching systems and Height adjustable tables
- Powder coated steel construction
- 2 sets of spacers included to accommodate needed spacing between 1" - 2.2"
- Includes installation hardware

MODEL #

**SPACERKIT-KBD**

\*NOT COMPATIBLE WITH CPULOCK



## SPACERKIT

### INNER BRACKET

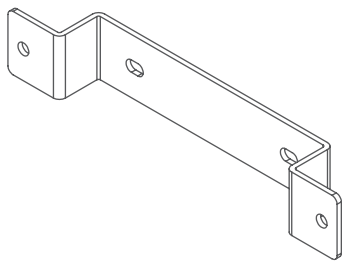

## SIDE

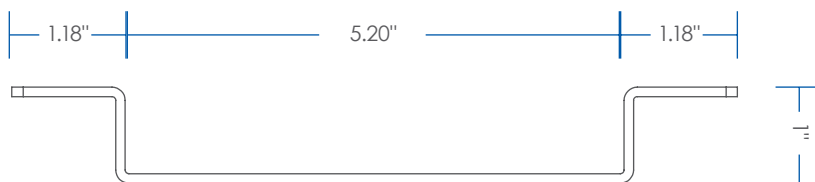

## TOP

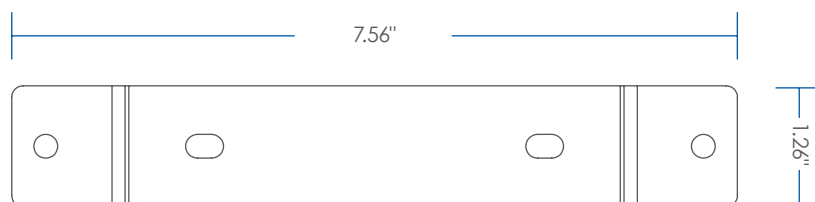

## SPACERKIT

### FRONT BRACKET

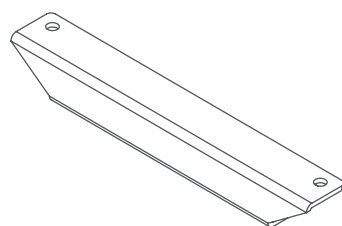

## FRONT

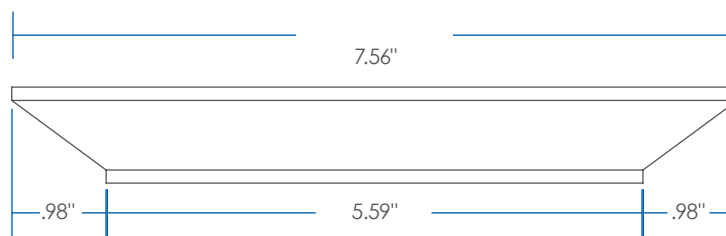

## TOP

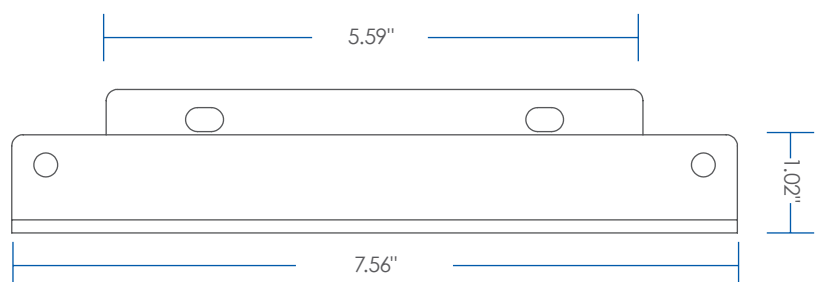

## SIDE

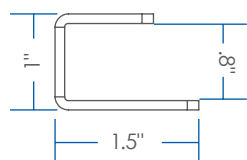

## BOTTOM

