

esi

assembly and operation instructions

Lotus VE™

sit-stand workstation

MODEL #'s:

LOTUS-VE1-BLK

LOTUS-VE2-BLK

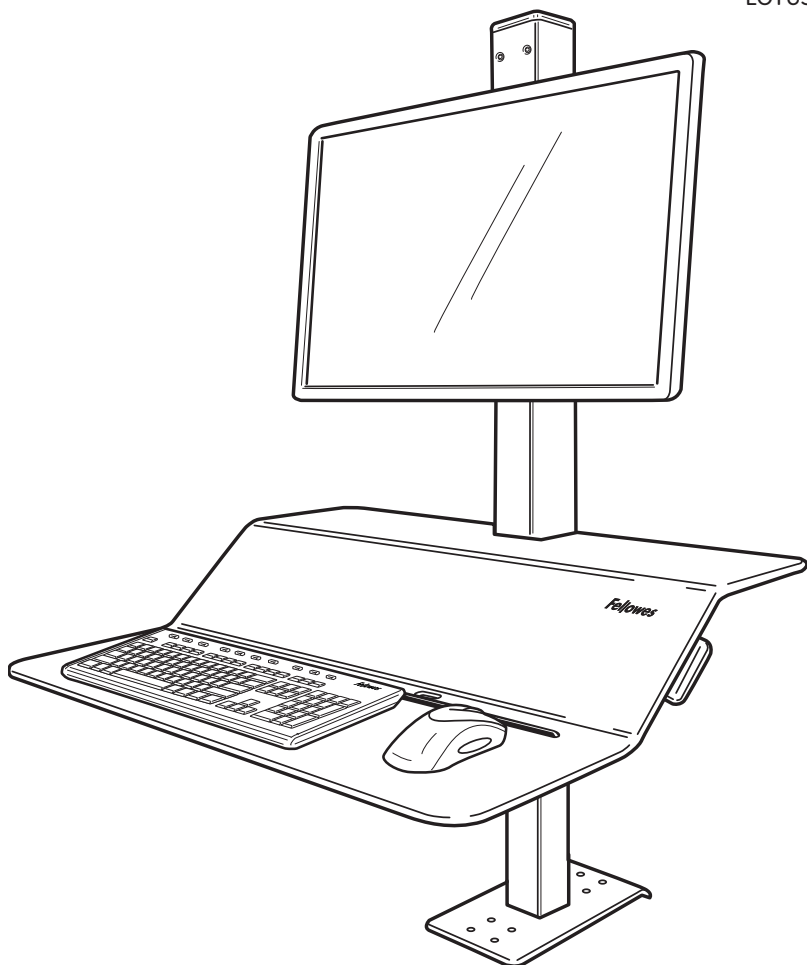

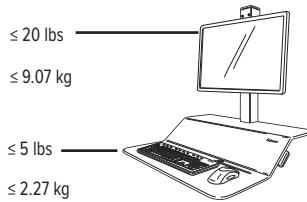

safety instructions/warning

Read and follow all instructions and warning before use.

- **WARNING: PINCH POINT! KEEP HANDS CLEAR OF SUPPORT BARS DURING OPERATION. SERIOUS INJURY MAY OCCUR.**
- **DO NOT EXCEED MAXIMUM STATED WEIGHT CAPACITY. SERIOUS INJURY OR PROPERTY DAMAGE MAY OCCUR.**
- **CAUTION: Lift hazard! Two people are required to move workstation. Serious injury may occur.**
- Ensure cable lengths are long enough and follow the cable routing instruction in this manual. Failure to follow these instructions may result in equipment damage or personal injury.
- **DO NOT lean on the keyboard platform.**
- This product has a gas strut lift assistance and should never be used with less than 5 lbs. (2.2kg) of weight.
- Make sure the desk or mounting surface is level and can support the combined weight of the workstation and accessories.
- Remove all equipment and accessories from the workstation before moving.
- Manufacturer certifies that product meets or exceeds applicable ANSI/BIFMA standards.

contents

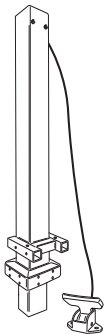

A tower pole

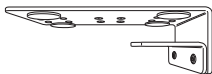

B base plate

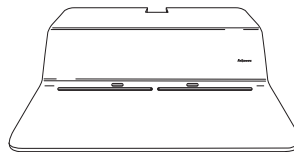

C platform

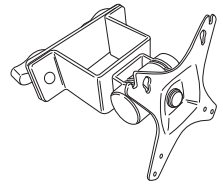

D vesa assembly



E clamp bar

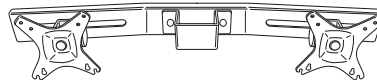

G dual vesa assembly

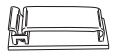

J cable clip

H m6X12mm bolt (6)



J m3X55mm allen key



L m6X95mm allen key



I m6X25mm bolt (3)



M m8X80mm bolt (2)



K m4X12mm bolt (8)



K m4X55mm allen key



N 13mm hex wrench (2)





step 1

Attach the Tower Pole to the Base Plate

- Choose one of three locations to attach the Tower Pole to the Base Plate depending on your desk depth. Furthest set to the rear for 23.6" (600mm), middle set for 27.5" (700mm) and the front set for 31.5" (800mm) depth desks.
- Use four M6x25mm bolts and the M4x55mm Allen Key to attach the Tower Pole to the Base Plate.

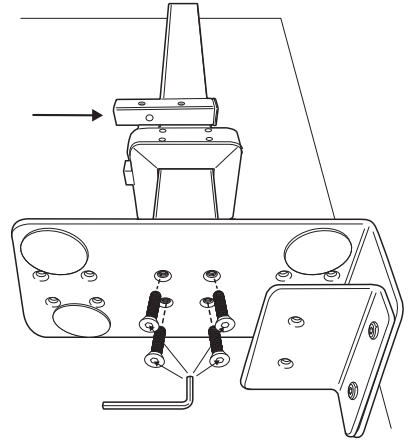

step 2

Prepare Clamp

- The base clamp comes pre-assembled to fit standard thickness desks (see option A image). If your desk is thicker you can remove the two M6x12mm bolts using the M4x55mm Allen Key and flip the base clamp (see option B image). Re-install the M6x12mm bolts using the M4x55mm Allen Key.
- Insert two M8x80mm bolts into the Base Clamp, only a few turns each..

option A

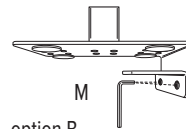

option B

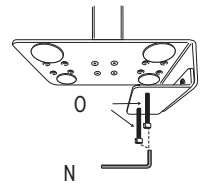
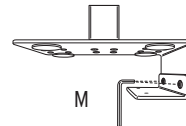

step 3

Attach Base to Table

- Slide the Base Plate onto the rear of the desk.
- Place the Clamp Bar on top of the M8x80mm bolts. Ensure the tip of the bolts align to the holes on the Clamp Bar.
- Tighten the M8x80mm bolts with the M6x95mm Allen Key until the Clamp Bar is secured to the desk.

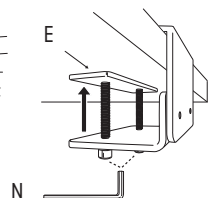
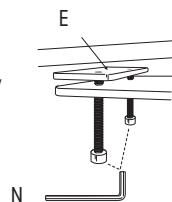
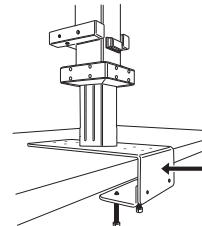



step 4

Attach the Platform

- Slide the platform onto the tower pole and secure it with four M6x12mm bolts and the M4x55mm Allen Key.

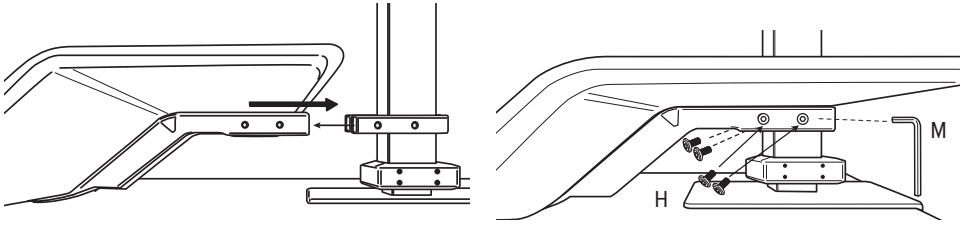

step 5

Attach VESA Assembly to Tower Pole

- Option 1: Single Monitor Version

Unscrew the VESA Knobs from the VESA Assembly. Place the bracket on the front-side of the tower pole and the support bar on the rear. Tighten knobs to secure Assembly to pole.

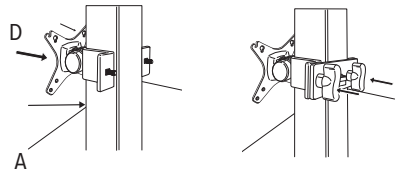

- Option 2: Dual Monitor Version

Unscrew the VESA Knobs from the Dual VESA Assembly. Place the bracket on the front-side of the tower pole and the dual cross bar on the rear. Tighten knobs to secure Dual Assembly to pole.

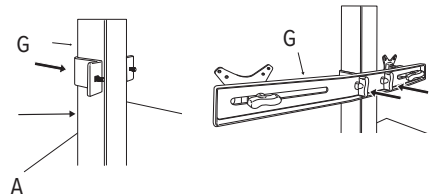

step 6

Attach Monitors

- Insert two M4x12mm bolts into the top two holes of monitor(s). Do not tighten all the way.
- Hook the monitor onto the VESA Assembly and add two additional M4x12mm bolts to the bottom two holes. Tighten all four bolts.
- To adjust the VESA Assembly tension remove the plastic cap and use the provided 13mm Hex Wrenches

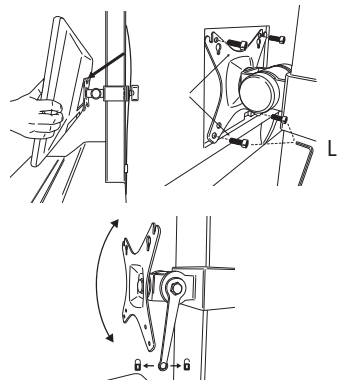



step 7

Attach the Lever to the Platform

- Attach the Handle on the left or right side, using two M6x12mm bolts and M4x55mm Allen Key.
- Remove the cable tie from the handle. 

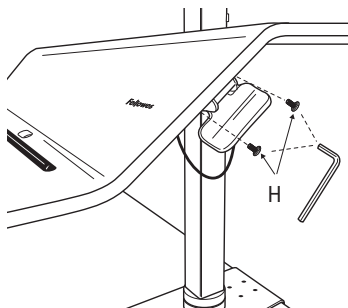

step 8

Setup Cable Management

- Engage the lever to raise the platform to the highest position.
- Adhere two cable clips under the Platform (refer to picture for specific locations).
- Route the keyboard and mouse cords through the openings in the keyboard platform.
- Neatly guide your cords to the rear of the product. Use the additional cable clip in a location that best suites your setup.

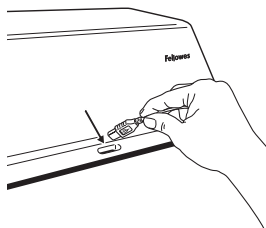
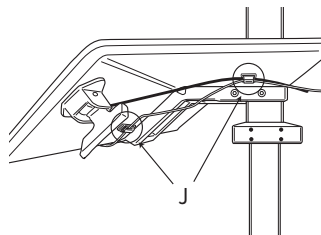

usage guidelines



45

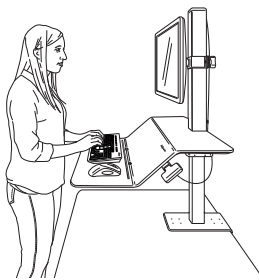

15





evolution of motion

Lotus™ VE

sit-stand workstation

Please contact Customer Service with any questions or comments at 800.833.3746 or visit our website at esiergo.com

ESI LOTUS™ VE 5-YEAR LIMITED WARRANTY

ESI (the "Company") warrants this product to be free from defects in material and workmanship appearing within five (5) years from the date of the original purchase of the product. If such a defect appears during the warranty period, the Company will (at its sole option) either repair or replace the defective product with no charge for service or parts or refund the purchase price.

This warranty applies only to the initial retail purchaser and does not cover claims resulting from misuse, failure to follow instructions on installation and use, neglect, use of unauthorized attachments, commercial use, use on a current or voltage other than specified on the product, or unauthorized service during the warranty period on conditions otherwise covered by warranty.

THE DURATION OF ANY IMPLIED WARRANTIES, INCLUDING BUT NOT LIMITED TO ANY IMPLIED WARRANTIES OF MERCHANTABILITY OR FITNESS FOR A PARTICULAR PURPOSE, IS EXPRESSLY LIMITED TO THE DURATION OF THIS LIMITED WARRANTY.

UNLESS REQUIRED BY APPLICABLE LAW, THE CUSTOMER'S EXCLUSIVE REMEDY FOR BREACH OF THIS WARRANTY OR ANY IMPLIED WARRANTY OR OF ANY OTHER OBLIGATION ARISING BY OPERATION OF LAW OR OTHERWISE SHALL BE LIMITED AS SPECIFIED HEREIN TO REPAIR, REPLACEMENT OR A REFUND OF THE PURCHASE PRICE, AT THE COMPANY'S SOLE OPTION.

UNDER NO CIRCUMSTANCE WILL THE COMPANY, ITS AFFILIATES, SUBSIDIARIES, RELATED ENTITIES, RESELLERS OR THEIR RESPECTIVE OFFICERS, DIRECTORS OR EMPLOYEES OR THOSE PERSONS FOR WHOM THEY ARE BY LAW RESPONSIBLE, BE LIABLE FOR CONSEQUENTIAL OR INCIDENTAL DAMAGES SUBSTAINED IN CONNECTION WITH THE PRODUCT. THE COMPANY AND THESE OTHER PARTIES DO NOT ASSUME OR AUTHORIZE ANY REPRESENTATIVE OR OTHER PERSON TO ASSUME FOR ANY OF THEM ANY OBLIGATION OR LIABILITY OTHER THAN AS IS EXPRESSLY SET FORTH HEREIN.

The duration, terms and conditions of this warranty are valid worldwide, except where different limitations, restrictions or conditions may be required by local law.

To make a warranty claim, contact ESI at 800-833-3746 or customerservice@esiergo.com. You must provide proof of purchase, such as the original purchase order number.