



Kata™ EX4-FM

Quad fixed + motion monitor arm

Kata™EX4-FM

Quad fixed + motion monitor arm



tension adjustment



integrated tool storage



grommet mount



desk clamp



connection sleeve

Product specs

- Finger touch dynamic height adjustment
- Recommended for worksurfaces 36.0" deep or less
- 32.2" arm extension
- 5.6" arm retraction
- +90°/-45° monitor tilt
- ±90° VESA rotation
- 28.0" pole height (*includes base*)
- 4.0 lb.–20.0 lb. weight capacity (*per arm*)
- VESA 75mm/100mm quick release
- 180° lock-out feature
- Desk clamp mount only
- Tension adjustment indicator for precision installation
- Each connection sleeve can accommodate up to three monitors depending on the configuration
- Partially assembled for quick installation
- Integrated cord management
- Integrated tool holder
- Meets or exceeds ANSI/BIFMA x5.5 guidelines
- 32.0" max. monitor width
*Bezel measured left to right,
Max width is contingent on weight capacity
Note: monitor height/weight might limit size*
- Warranty: 15 yr.
- Designed for ESI by Roger Webb Associates of London, England

Model #	List price
<input type="radio"/> KATAEX4-DC-FM-SLV	\$1,596
<input checked="" type="radio"/> KATAEX4-DC-FM-BLK	\$1,596
<input type="radio"/> KATAEX4-DC-FM-WHT	\$1,596

KataEX monitor arm key

F - Fixed monitor arm

M - Motion monitor arm

S - Slider mount

esi

800.833.3746
esiergo.com

Kata™ EX4-FM

Quad fixed + motion monitor arm

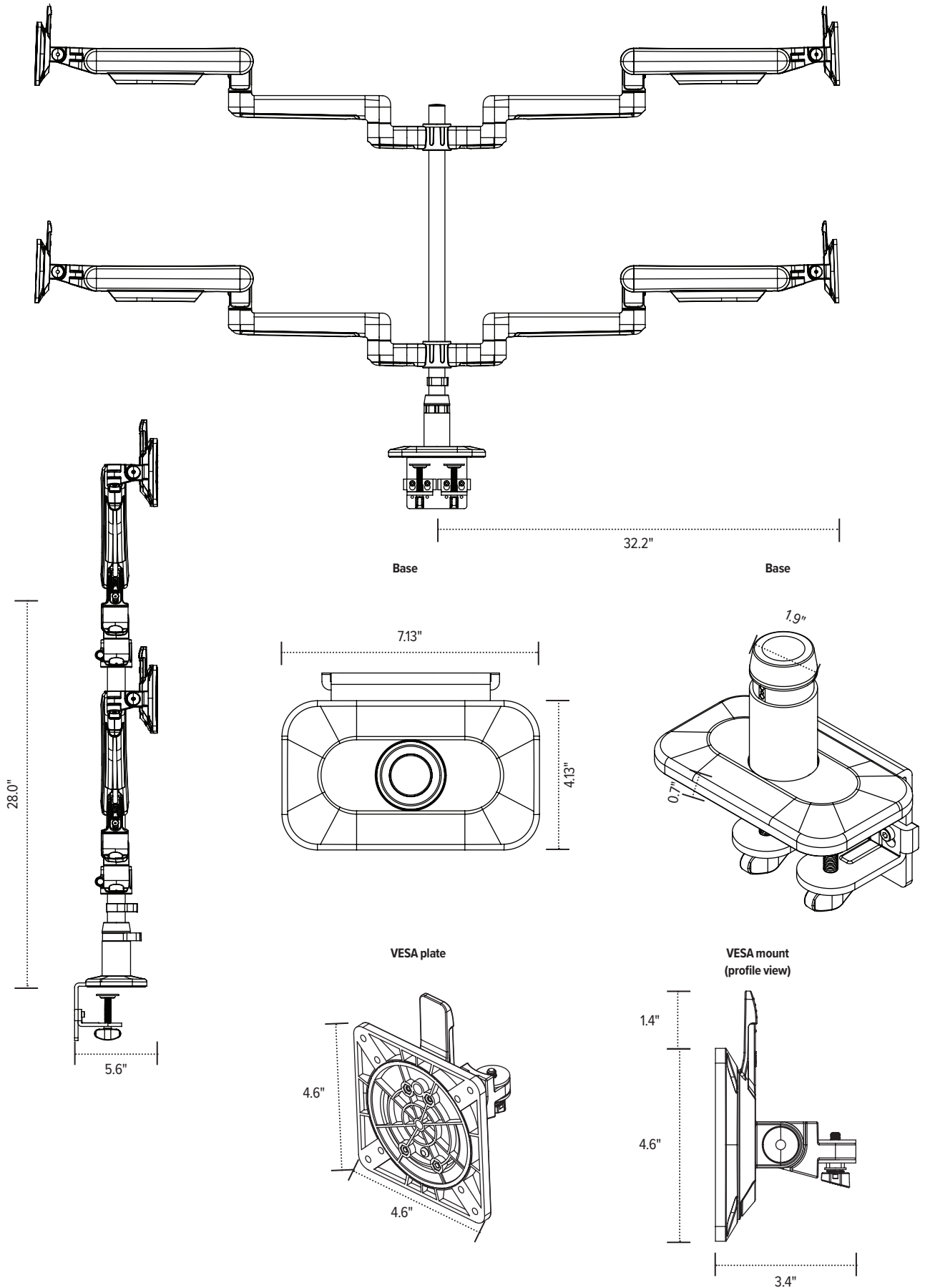

esi

800.833.3746
esiergo.com