

ALL-FLEX: Disassembly Instructions

ALL-FLEX Assembled

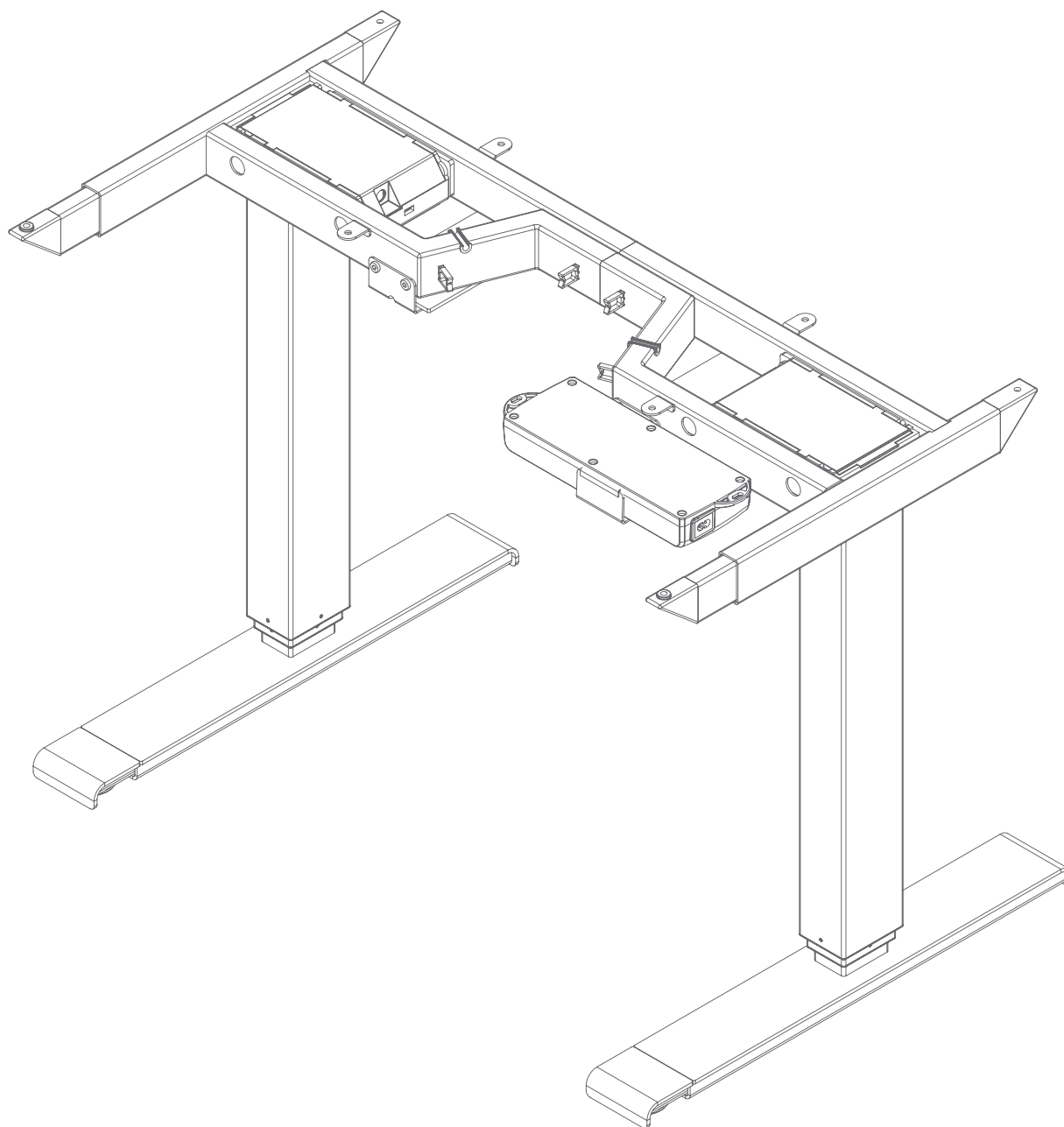

ALL-FLEX: Disassembly Instructions

ALL-FLEX Components for breakdown

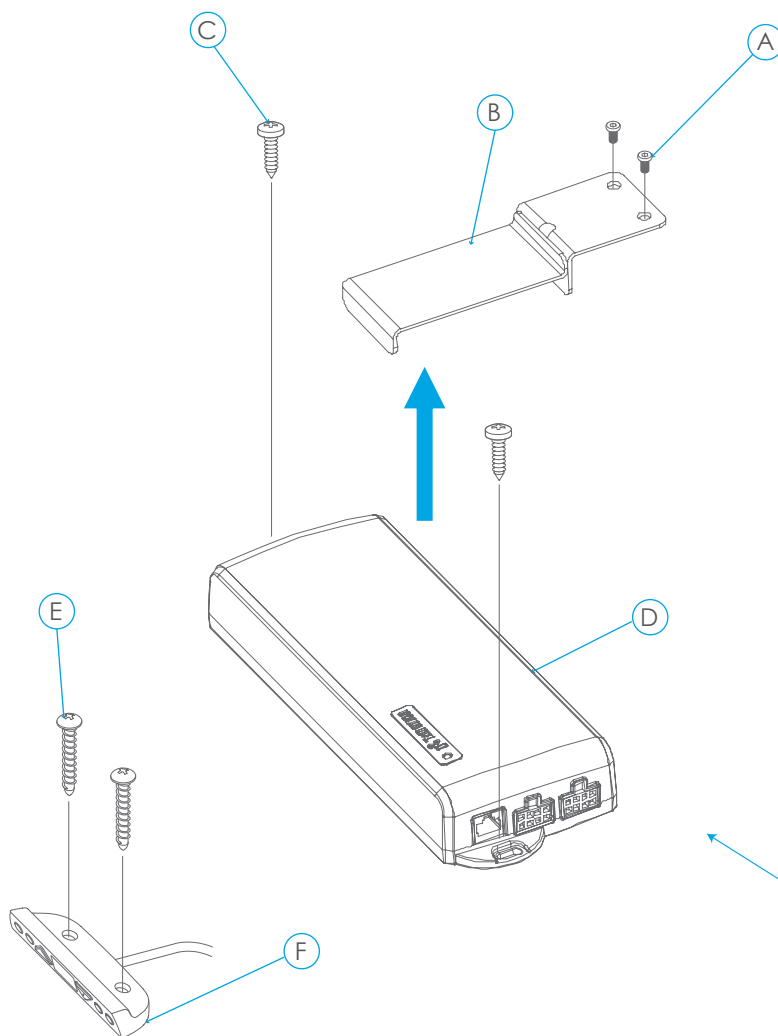

Material Identification

A: M6x12 Screws

- Steel

B: Control Unit Bracket

- Steel

C: Ø5x18 Wood Screws

- Steel

D: Control Unit

- Plastic

E: Ø4x23 Wood Screws

- Steel

F: Digital Keypad

- Plastic

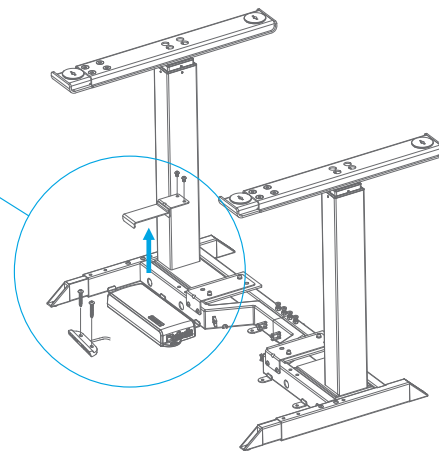

Recommended Tools



Gloves



Goggles



4mm Allen Wrench



Phillips Screwdriver

ALL-FLEX: Disassembly Instructions

ALL-FLEX Components for breakdown

Material Identification

A: Base

- Steel 

B: M10x20 Screws

- Steel 

C: Feet

- Plastic

D: Top Support Caps

- Plastic

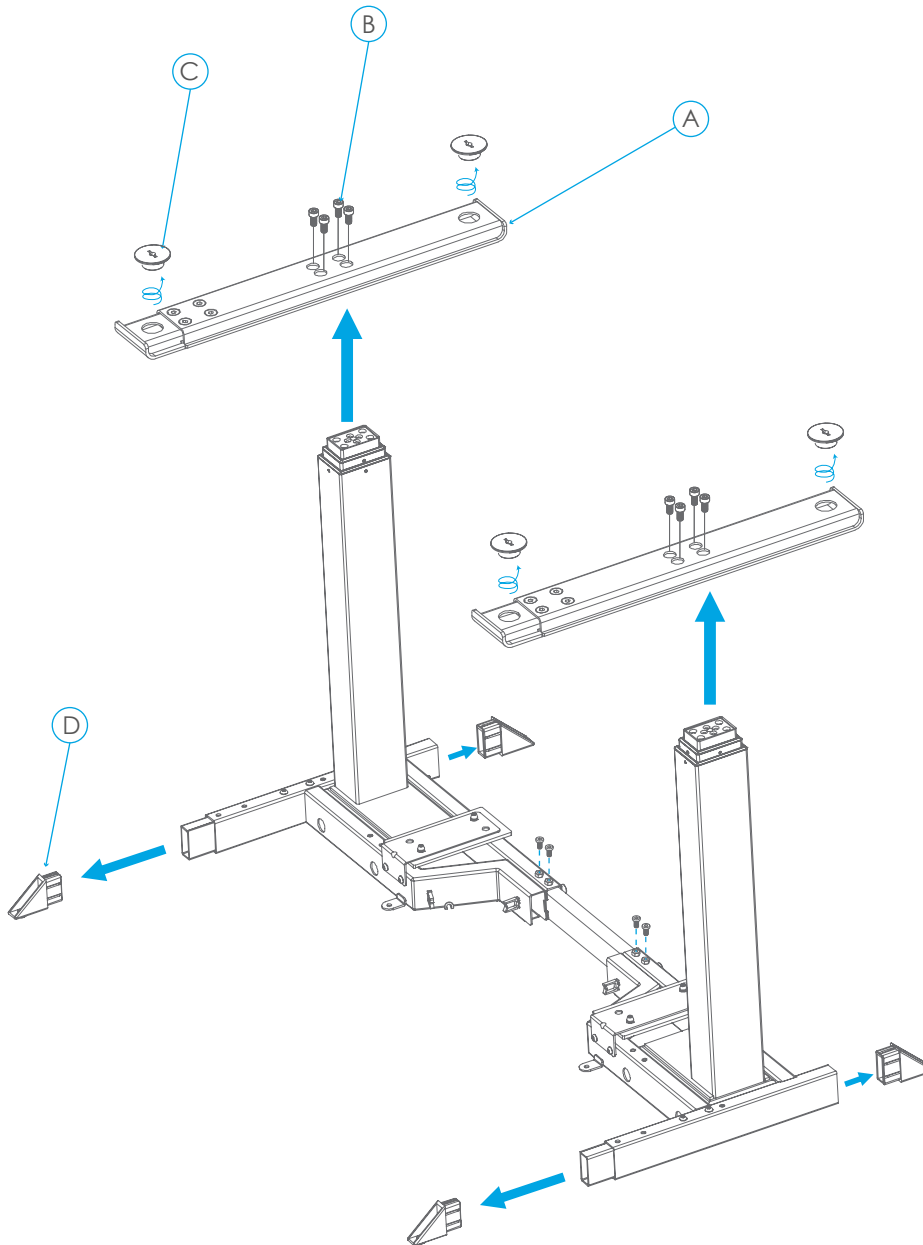

Recommended Tools



Gloves



Goggles



5mm Allen Wrench



Phillips Screwdriver



Flathead Screwdriver

ALL-FLEX: Disassembly Instructions

ALL-FLEX Components for breakdown

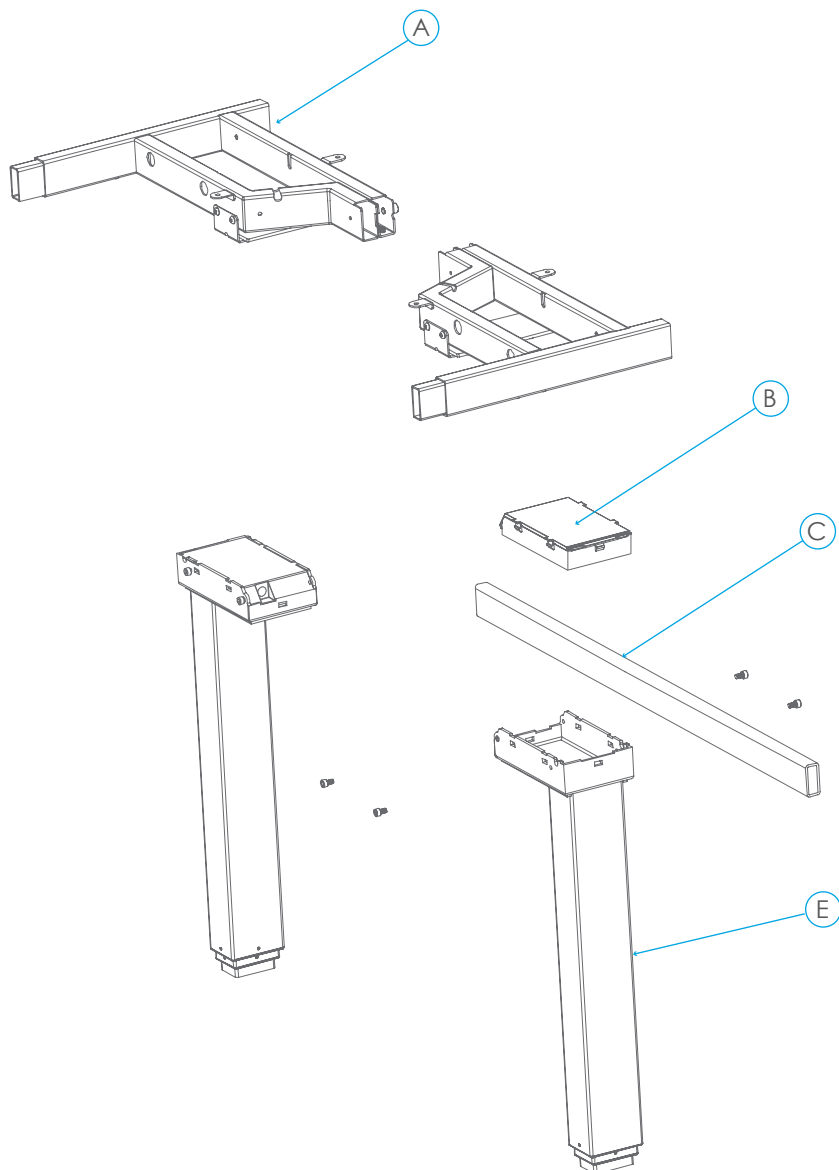

Material Identification

A: Frame

- Steel 

B: Leg Motors (Optional)

- Plastic

C: Channel

- Steel 

D: M6x12 Screws

- Plastic

E: Legs

- Steel 

Recommended Tools



Gloves



Goggles



4mm Allen Wrench



Phillips Screwdriver