

Edge[®]

single monitor arm

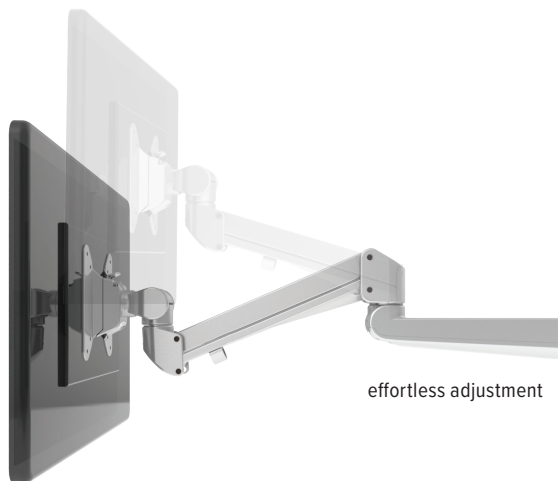

effortless adjustment



cable management



landscape/portrait rotation



grommet mount



desk clamp



integrated allen key storage



VESA quick release

Product specs

- Finger touch dynamic height adjustment
- Recommended for worksurfaces 24.0"–36.0" deep
- 12.0" height adjustment range
 - 7.0"–19.0" (low/high)
- 22.0" arm extension
- 4.0" arm retraction
- $\pm 90^\circ$ monitor tilt
- $\pm 90^\circ$ VESA rotation
- 6.5 lbs.–17.6 lbs. weight capacity
- VESA quick release
- 180° lock-out feature
- Desk clamp and grommet mount included
- Exceeds BIFMA x5.5 requirements
- Benching system mount(s) available. Call the Customer Service Dept for details
- Warranty: 15 yr.



Model

List price

<input type="radio"/> EDGE-SLV	\$356
<input checked="" type="radio"/> EDGE-BLK	\$356
<input type="radio"/> EDGE-WHT	\$356

Conversion

Reuse most of the parts in your single Edge arm when you convert up to the Edge2 with our simple kit. *Conversion kit sold separately*

Edge

single monitor arm

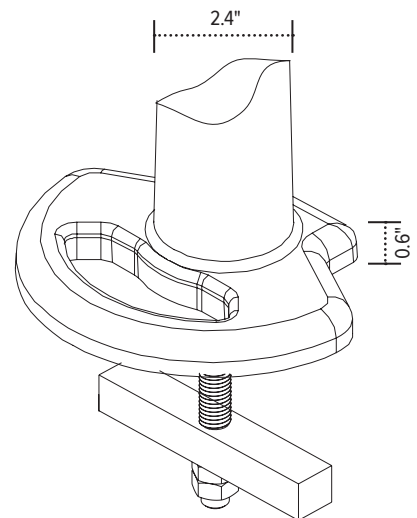
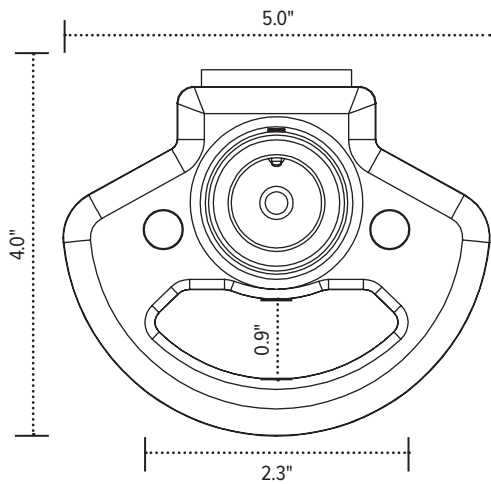
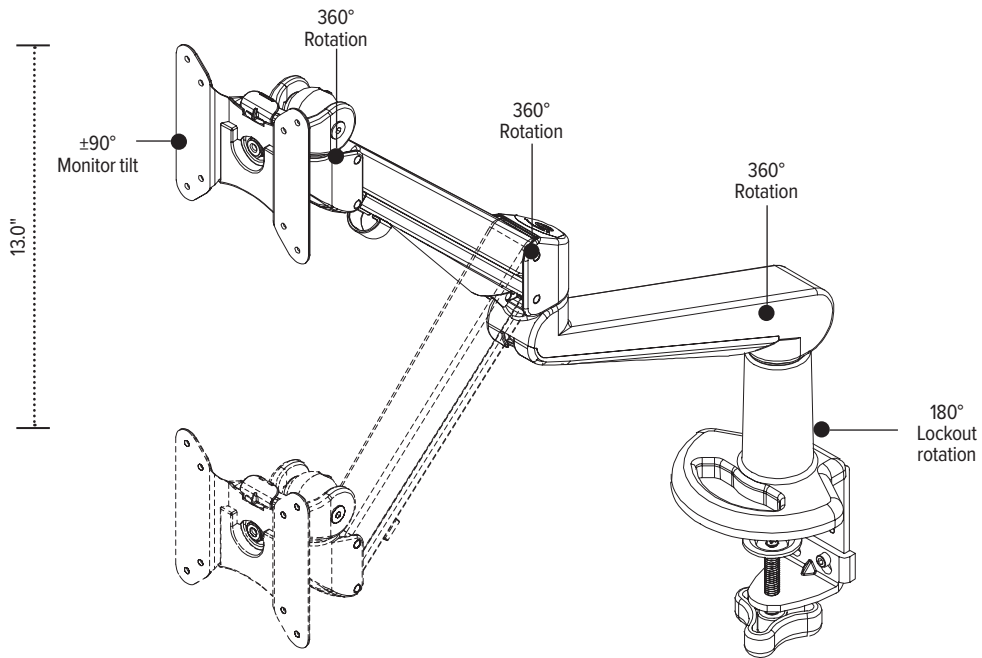

esi

800.833.3746
esiergo.com