



Kata™ EX4-FF

Quad fixed + fixed monitor arm

Kata™ EX4-FF

Quad fixed + fixed monitor arm



tension adjustment



integrated tool storage



grommet mount



desk clamp



connection sleeve

Product specs

- Manual height adjustment
- Recommended for worksurfaces 30.0" deep or less
- 31.7" arm extension
- 7.1" arm retraction
- +90°/-45° monitor tilt
- ±90° VESA rotation
- 28.0" pole height (*includes base*)
- Up to 20.0 lb. weight capacity (*per arm*)
- VESA 75mm/100mm quick release
- 180° lock-out feature
- Desk clamp mount only
- Tension adjustment indicator for precision installation
- Each connection sleeve can accommodate up to three monitors depending on the configuration
- Partially assembled for quick installation
- Integrated cord management
- Integrated tool holder
- Meets or exceeds ANSI/BIFMA x5.5 guidelines
- 32.0" max. monitor width
Bezel measured left to right,
Max width is contingent on weight capacity
Note: monitor height/weight might limit size
- Warranty: 15 yr.
- Designed for ESI by Roger Webb Associates of London, England

| Model # | List price |
|--|------------|
| <input type="radio"/> KATAEX4-DC-FF-SLV | \$1,232 |
| <input checked="" type="radio"/> KATAEX4-DC-FF-BLK | \$1,232 |
| <input type="radio"/> KATAEX4-DC-FF-WHT | \$1,232 |

KataEX monitor arm key

F - Fixed monitor arm

M - Motion monitor arm

S - Slider mount

esi

800.833.3746
esiergo.com

Kata™ EX4-FF

Quad fixed + fixed monitor arm

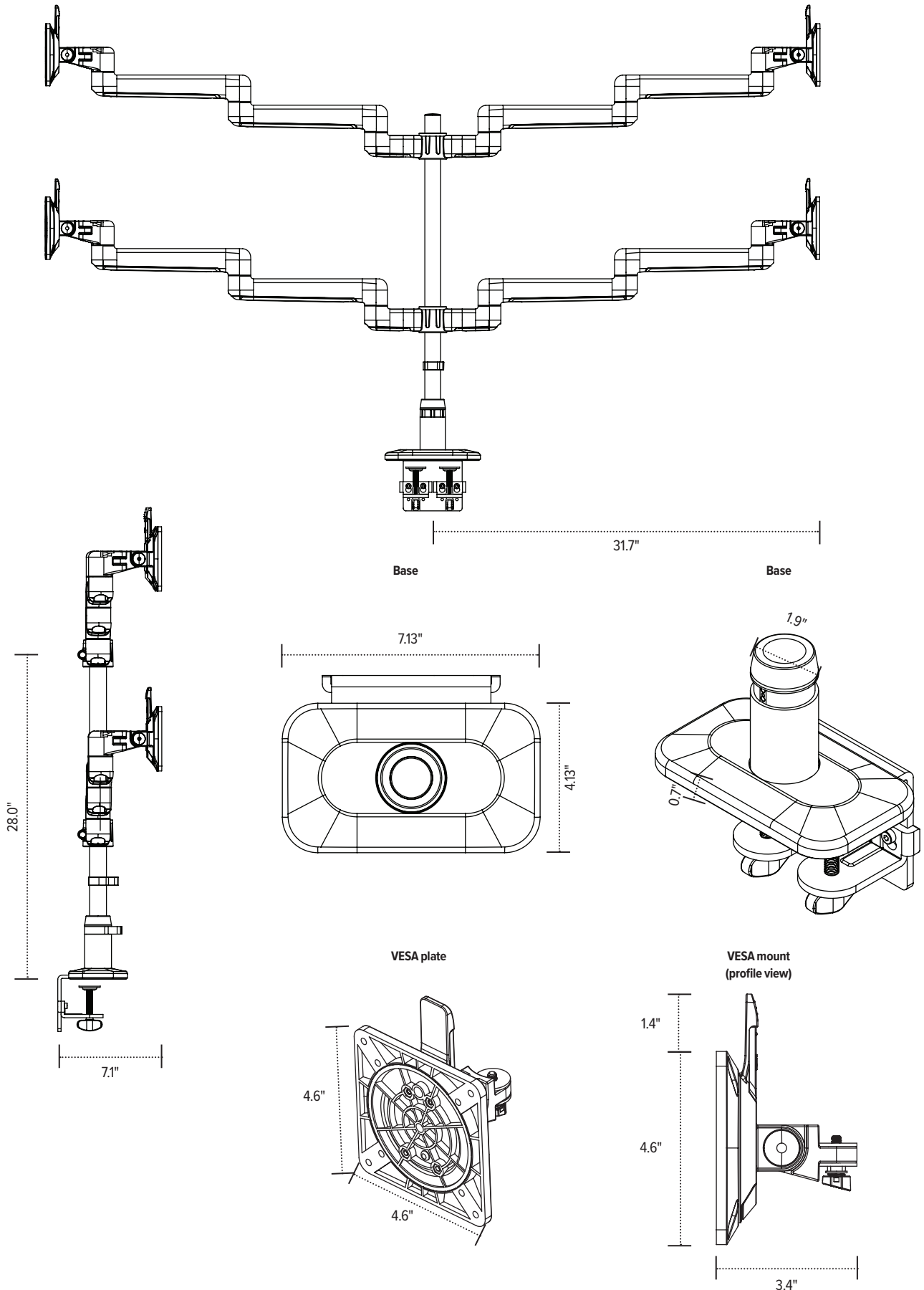

esi

800.833.3746
esiergo.com