

# Benching Solutions

Steelcase® Frameone monitor arm benching adapter

# Benching Solutions

Steelcase® Frameone monitor arm benching adapter



## Product Specs

- E-FOMT-SLV compatible ESI monitor arms:
  - Evolve monitor arms: single, dual and triple configurations only
  - Edge®: single configuration only
- Holds up to three monitors (15.4 lbs. per slider mount arm, 17.6 lbs. per VESA mount)
- Fits easily on standard Edge and Evolve product nesting on base
- Available on GSA contract
- Warranty: 15 yrs.

## Model #

E-FOMT-SLV

esi

800.833.3746  
esiergo.com

# Benching Solutions

Steelcase® Frameone monitor arm benching adapter

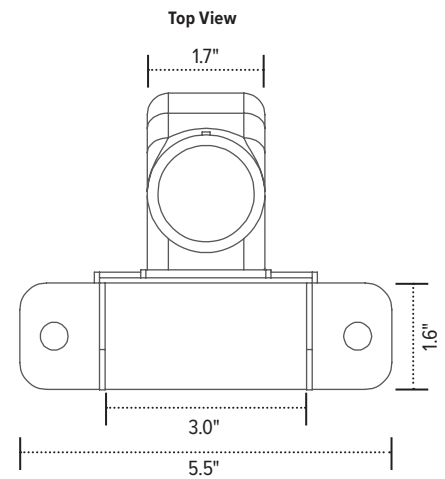
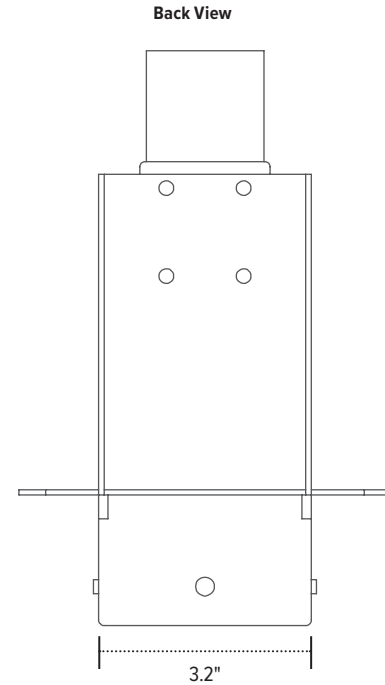
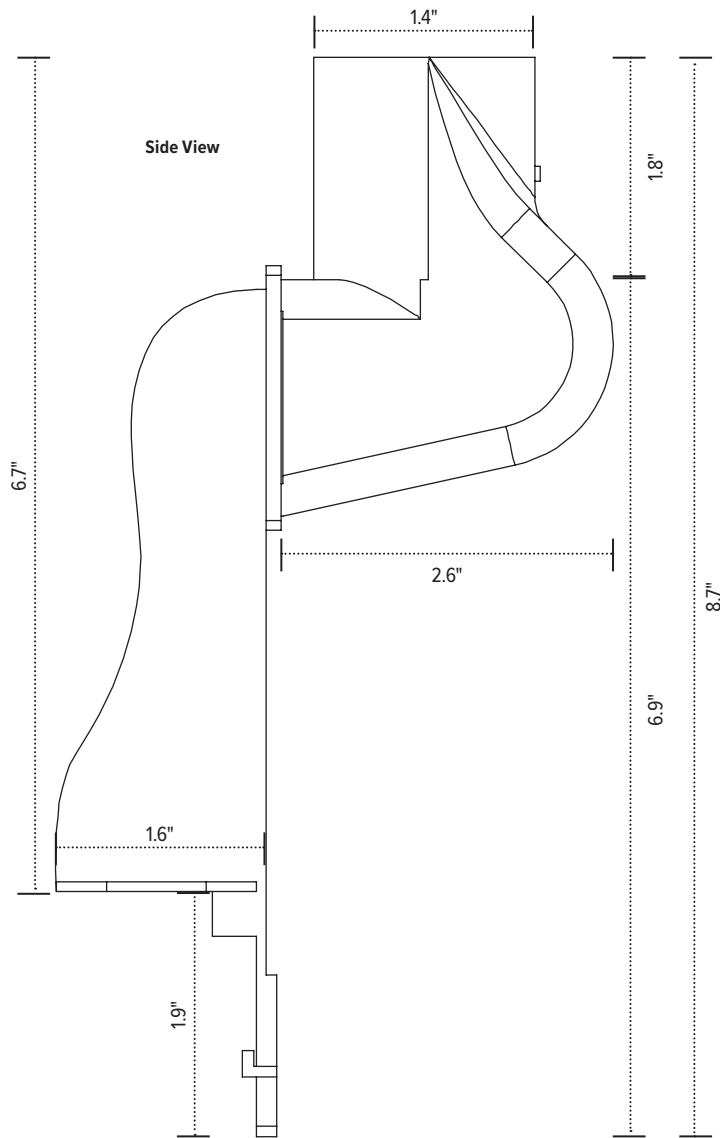

esi

800.833.3746  
esiergo.com

© 2018 Fellowes, Inc.