

esi | work gear



WOW01

workstation-on-wheels



Product Specs

- Pneumatic lift platform with wire controller
- 5-star base with heavy-duty casters (2 locking)
- Includes cable management system
- 26.5"w x 22.5"d top platform
- 13.0" platform height adjustment:
Low: 28.0" | High: 41.0"
- 28.0" diameter base
- 20 lbs. weight capacity
- Effortless height adjustment
- Ideal for mobile height adjustability
- Additional accessories available
- Warranty: 15 yrs.
- Available on GSA contract

Model

WOW01

heavy-duty
casters

WOW1

workstation-on-wheels

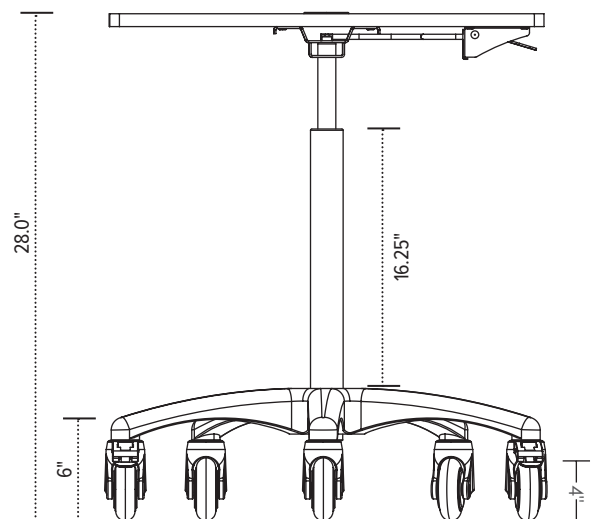
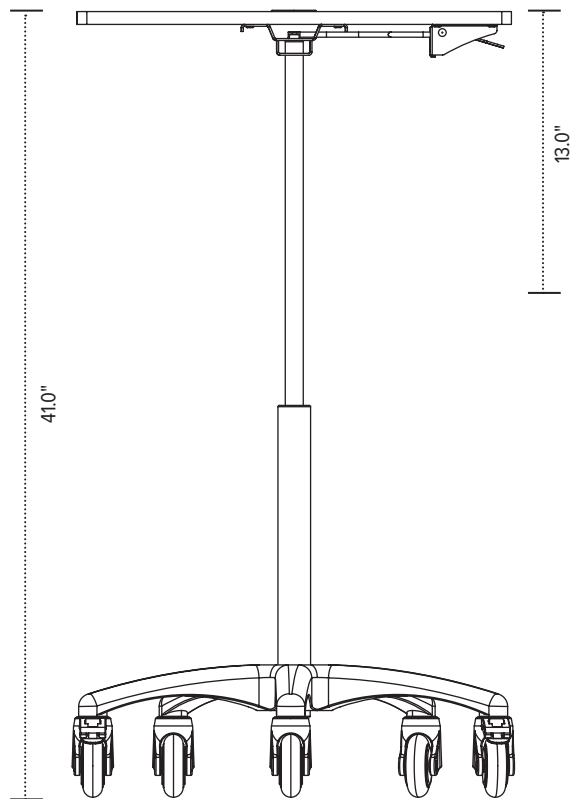
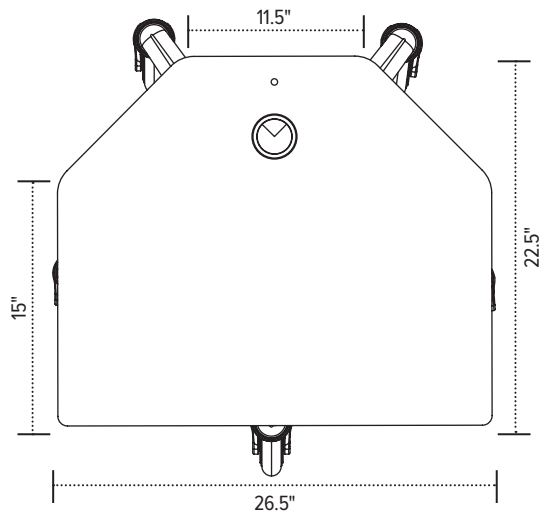

esi

800.833. 3746
esiergo.com