

## EDGE-SLAT

MONITOR ARM

Model EDGE-SLAT-SLV

EDGE-SLAT Rev A 2/17

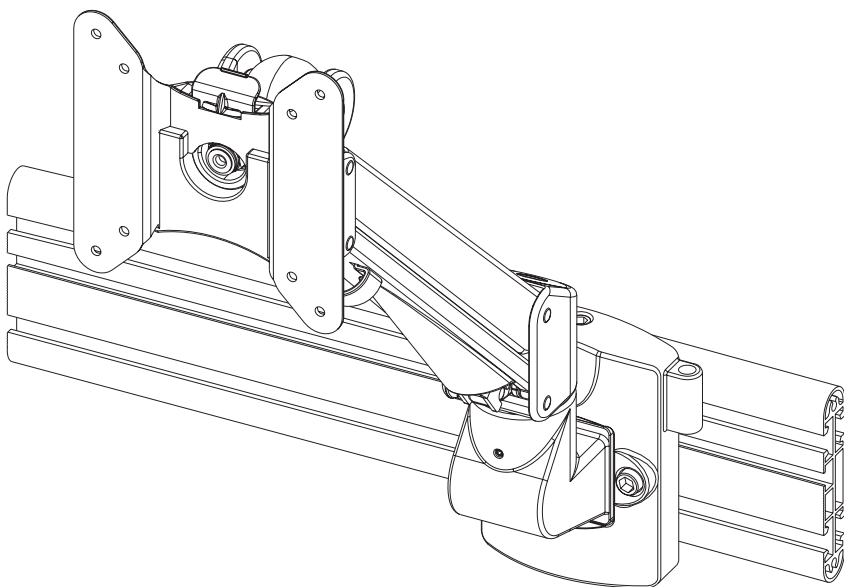



## ASSEMBLY AND ADJUSTMENT

## EDGE-SLAT MONITOR ARM

**PLEASE REVIEW** these instructions before beginning the installation. Check that all parts and tools shown below were provided with your order. Contact your supplier if any parts are missing. Do not discard the packaging until satisfied that the product operates to your satisfaction.

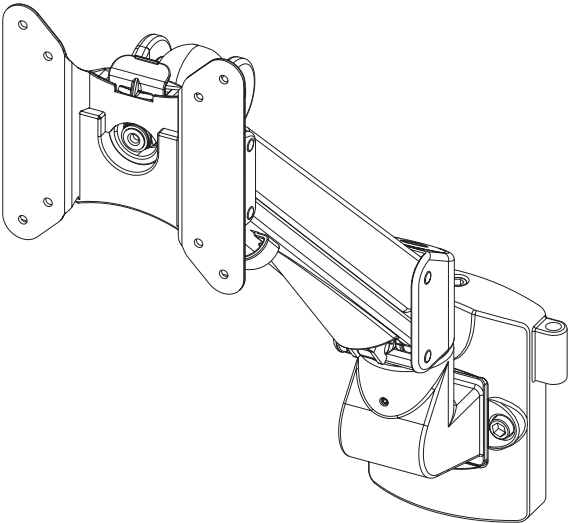
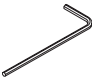
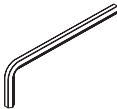
### PARTS AND TOOLS PROVIDED

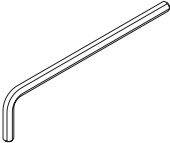
<div>Monitor Arm Assembly (1)</div> 		<div>2mm Allen Key (1)</div> 
		<div>4mm Allen Key (1)</div> 
<div>VESA Plate Screw (4)</div>  <div>M4x10</div>	<div>VESA Locking Screw (1)</div>  <div>M4x10</div>	<div>5mm Allen Key (1)</div> 

**CAUTION:** Hand-tighten screws only. Do **not** use power tools.

### ADDITIONAL TOOLS REQUIRED

- Phillips screwdriver

## Attach the Monitor Arm to the Slat

- Loosen or tighten the socket screw on top of the mounting plate to adjust the hooks to fit into the slot.  
— Use the 5mm Allen key.
- After fitting the hooks into the slot, tighten the socket screw to secure the monitor arm in position.

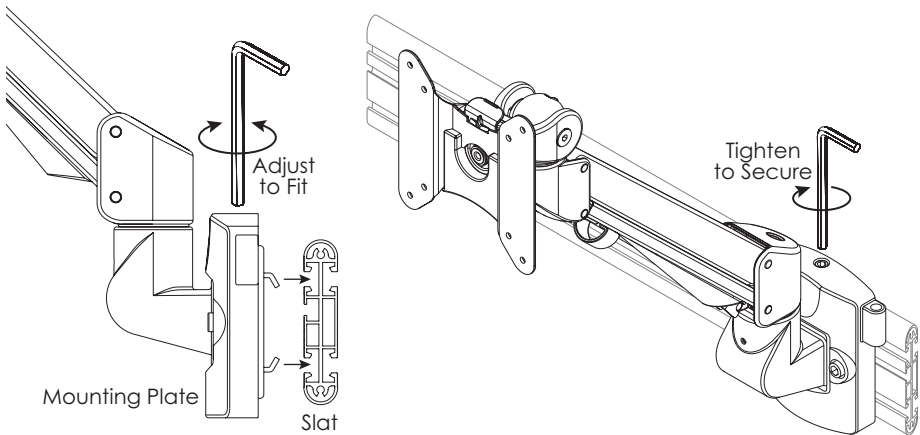

- If the arm is not securely in position, tighten the two socket screws on the left and right sides of the mounting plate, again using the 5mm Allen key.  
— If you have difficulty fitting the mounting plate hooks into the slat, you may need to loosen the side screws to back off the locking channels.

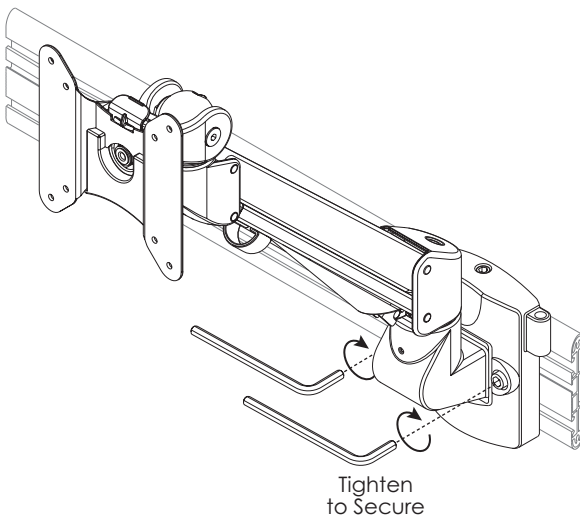

### Attach VESA Plate to Monitor

- Remove the VESA plate from the VESA mount by pressing down on the plastic tab to release the lock. Pull the plate upward to remove.

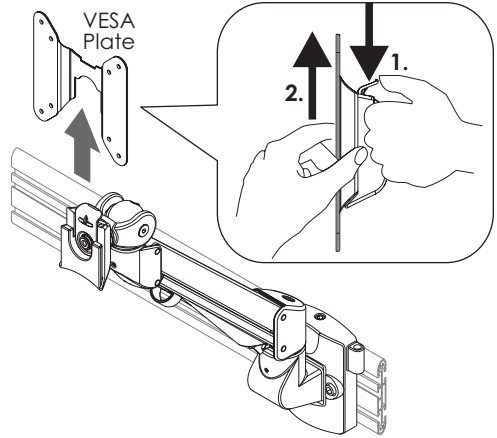

- Place the monitor face down on a flat surface. Align the VESA plate holes with the holes on the back of the monitor. Attach the VESA plate using the four VESA plate screws provided.
- There are two sets of four holes on the VESA plate. One set has holes 3.9" (100mm) apart, the other set has holes 3" (75mm) apart. Use the set that matches the holes on the monitor.

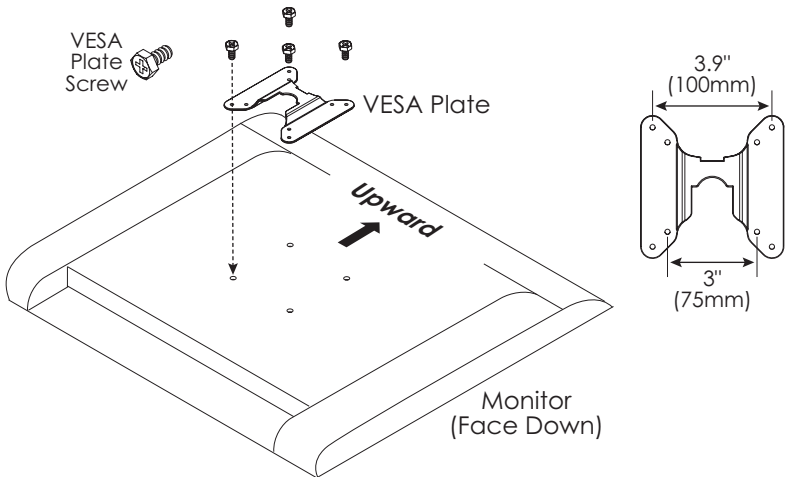

### Attach Monitor and VESA plate

- Slide the VESA plate (with monitor attached) back onto the VESA mount. Make sure the VESA plate clicks securely in place.
  - **Optional:** Install a VESA locking screw behind the VESA plate to prevent the tab on the VESA plate from releasing the monitors.

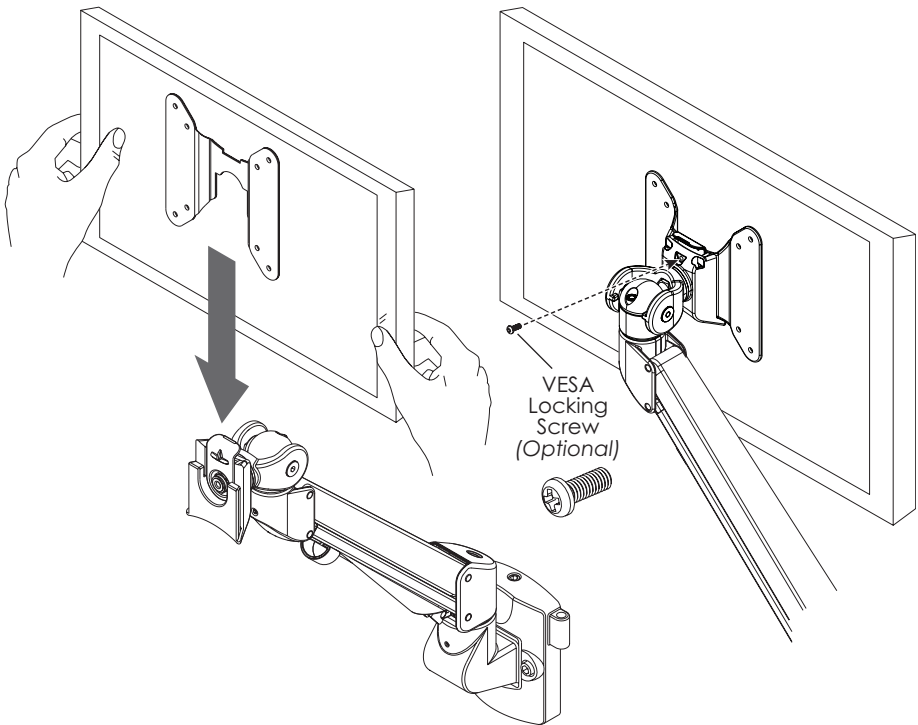

### Cable Management

- Use the cable clip to help manage the monitor cables. Pinch the clip to remove it from the monitor arm, and again when re-installing it with the cables captured.

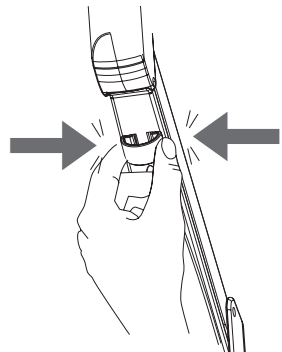

### Tension Adjustments

There are four possible swivel and tilt tension adjustments:

#### **1. Monitor swivel adjustment**

- Use the 2mm Allen key to adjust the set screw for the desired ease of monitor rotation.

#### **2. Monitor arm swivel adjustment**

- Use the 2mm Allen key to adjust the set screw for the desired ease of monitor arm rotation.

#### **3. Monitor tilt adjustment**

- Use the 4mm Allen key to adjust the set screw for the appropriate monitor weight.

#### **4. Monitor arm weight adjustment**

- Use the 5mm Allen key to adjust the set screw for the appropriate monitor weight.
- Weight capacity per arm is 6.5 lbs to 17.6 lbs (2.95 kg to 8 kg).

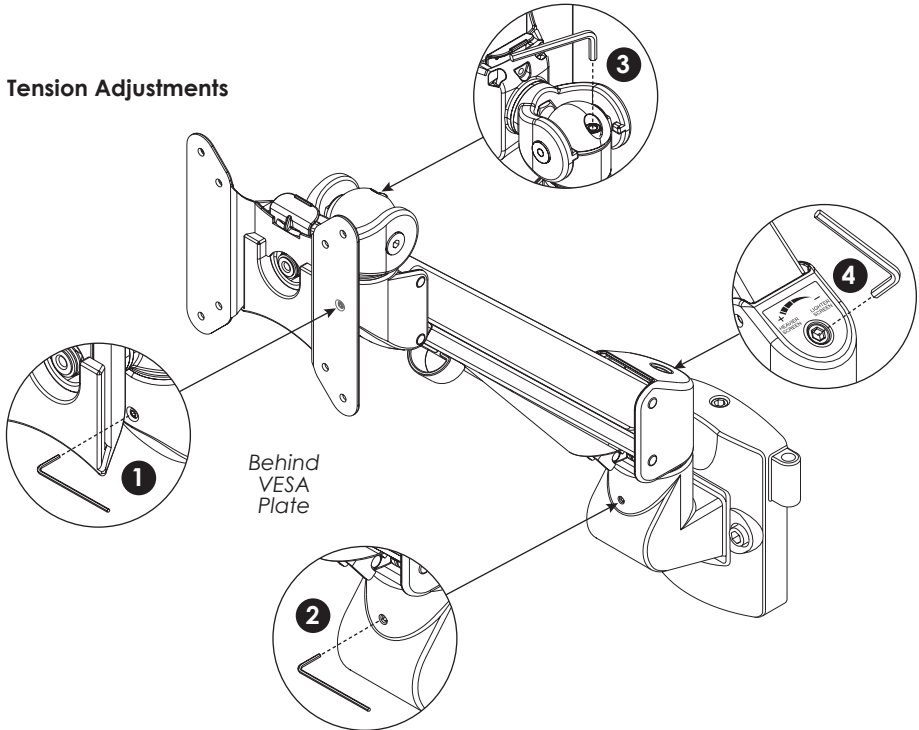

### Allen Key Storage

- Insert the Allen keys into the holes behind the VESA plate to store for future adjustment.
- Insert the two smaller Allen keys into the same hole.

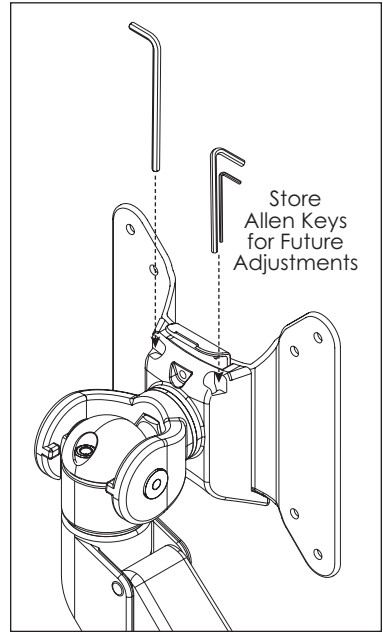



800.833.3746 | [esiergo.com](http://esiergo.com)