

EVOLVE-STUBBY

MONITOR ARM

Model EVOLVE-STUBBY-SLV
Model EVOLVE-STUBBY-BLK
Model EVOLVE-STUBBY-WHT

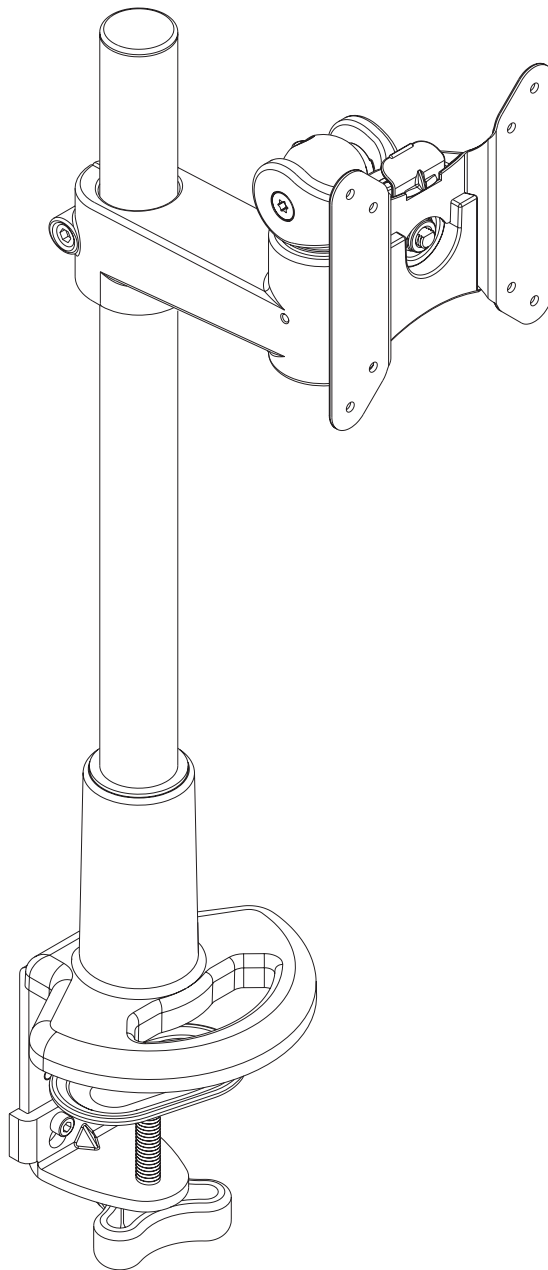







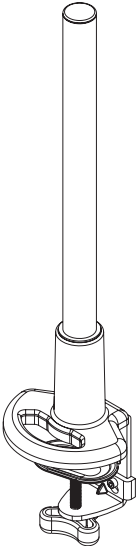
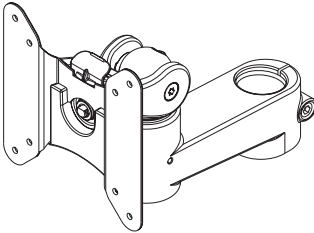

EVOLVE-STUBBY Rev A 2/17

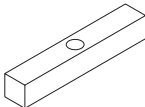
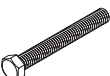

ASSEMBLY AND ADJUSTMENT

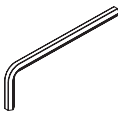
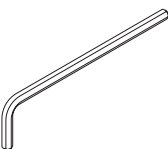
PLEASE REVIEW these instructions before beginning the assembly and adjustment procedures. Check that all the parts and tools listed below were provided with your order. Contact your supplier if any materials are missing. Do not discard the packaging until satisfied that the product operates to your satisfaction.

PARTS AND TOOLS PROVIDED

Pole Mount (1) 	Arm Stem Assembly (1) 	Clamp Pad (1) 	Grommet Mount Plate (1) 
		Grommet Bar (1) 	Grommet Bolt (1)  3x3/8-16
	Grommet Bolt Washer (1)  M10x27	Grommet Bolt Nut (2)  9/16x3/8-16	14mm Wrench (1) 
4mm Allen Key (1) 	5mm Allen Key (1) 	VESA Plate Screw (4)  M4x10	VESA Locking Screw (1)  M4x10
Pole Clip (2) 	CAUTION: Hand-tighten screws only. Do not use power tools.		

ADDITIONAL TOOLS REQUIRED

- Phillips screwdriver

Two Base Assembly Attachment Methods

- **Clamp method.** The base assembly is clamped to a table or desk surface that is between 0.6" (15mm) thick and 3" (76mm) thick. See below.

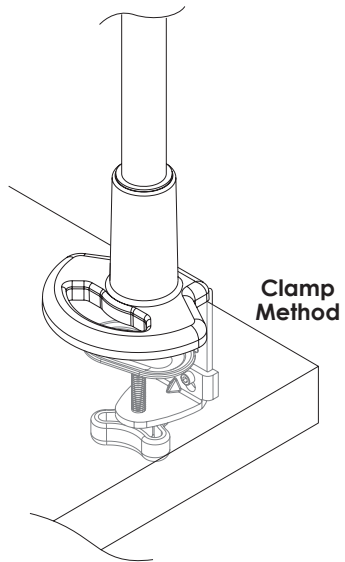

- **Grommet method.** The base assembly is secured through a grommet hole in the work surface, with a diameter between 0.78" (20mm) and 2" (51mm). Surface thickness must be between 0.6" (15mm) and 1.5" (38.1mm). See page 4.

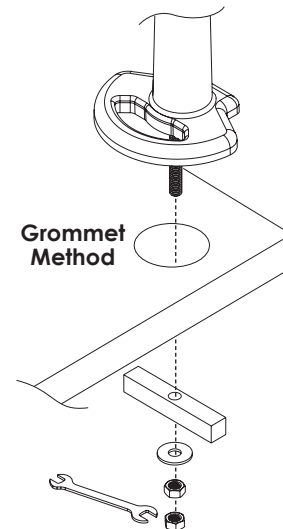

Clamp Method

The base assembly is shipped with the bottom clamp in the "upper attachment position." To change to the "lower attachment position" for thicker work surface, follow this procedure (see illustrations):

- Use the 4mm Allen key to remove the two screws holding the bottom clamp in position.
- Reattach the bottom clamp to the lower two holes. Tighten the screws securely using the Allen wrench.

CAUTION: Do not use a power drill. Clamp screws are rated at 102 in-lbs.

Upper Attachment Position (Standard)

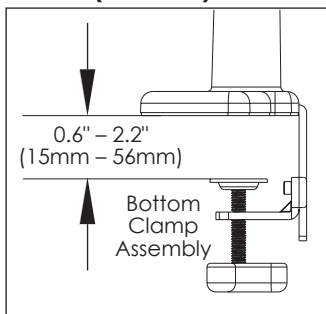

Lower Attachment Position (Optional)

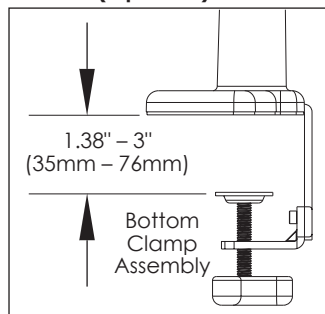

To Change: 1) Remove Upper Attachment Screws

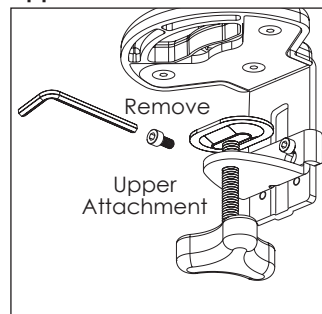

2) Re-Install Screws with Clamp in Lower Position

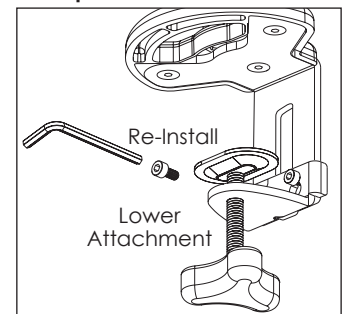

Attach Clamp Pad

- Peel the backing from the adhesive side of the clamp pad and adhere the pad to the bottom of the base, as shown. The pad protects the work surface.

Install Base Assembly

- Clamp the base assembly to the work surface. Be sure to tighten the knob securely.
- **Proceed to "Install Arm Stem Assembly" on page 5.**

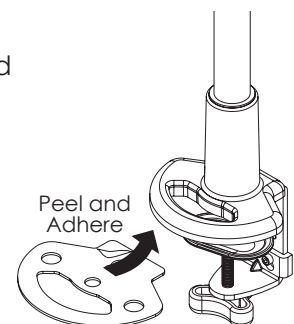

Grommet Method

This method can be used for work surfaces that have a grommet hole in an appropriate position. Surface thickness must be between 0.6" (15mm) and 1.5" (38.1mm), and the grommet hole diameter must be between 0.78" (20mm) and 2" (51mm).

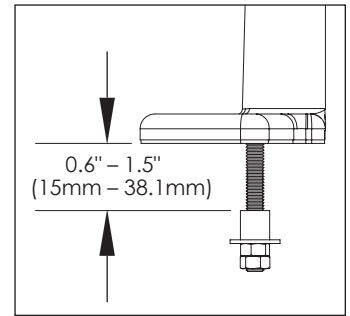

Remove Clamp Assembly

- Remove the standard clamp assembly from the base assembly. Use the 4mm Allen key to remove the three screws holding the clamp assembly in position. Retain the three screws.

Attach Grommet Assembly

- Place the grommet bolt in the large center hole on the grommet mount plate.
- With the grommet bolt in position, fasten the grommet mount plate and bolt to the monitor arm base with the three screws previously removed. As before, use the 4mm Allen key.

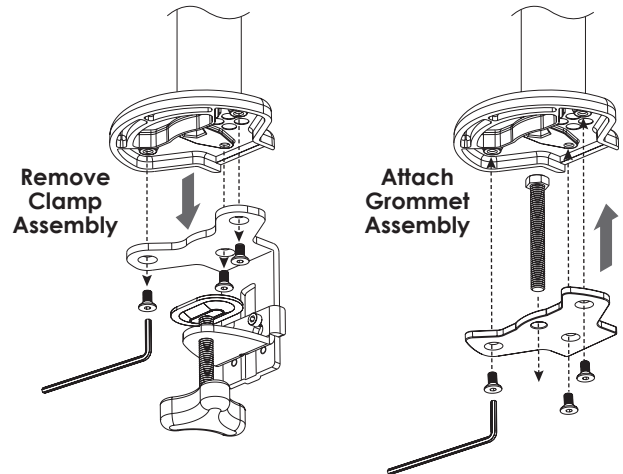

Attach Clamp Pad

- Peel the backing from the adhesive side of the clamp pad and adhere the pad to the bottom of the grommet mount plate, as shown. The pad protects the work surface.

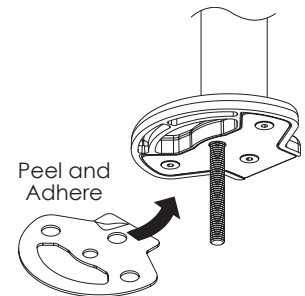

Install Base Assembly

- Place the base assembly over the grommet hole, with the bolt centered.
- The bolt must extend under the work surface a minimum of 1.3" (33mm).
- Secure the base assembly as illustrated.
 - Secure the grommet bar and washer with one of the grommet bolt nuts. Use the provided wrench to tighten the nut securely.
 - Tighten the second nut against the first to further secure the base assembly.
- Proceed to "Install Arm Stem Assembly" on page 5.

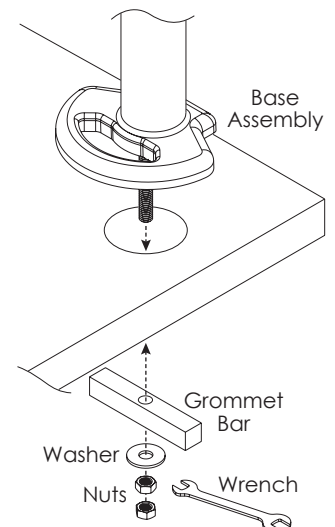

Install Arm Stem Assembly

- Loosen the socket screw on the arm stem using the 5mm Allen key.
- Slide the arm stem onto the pole.
- Position the arm stem at the desired height and orientation, and tighten the socket screw.

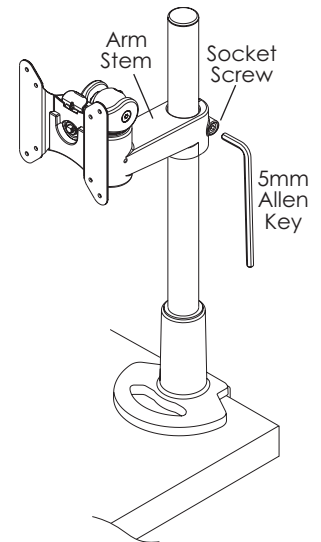

Attach VESA Plate to Monitor

- Remove the VESA plate from the VESA mount by pressing down on the plastic tab to release the lock. Pull the plate upward to remove.

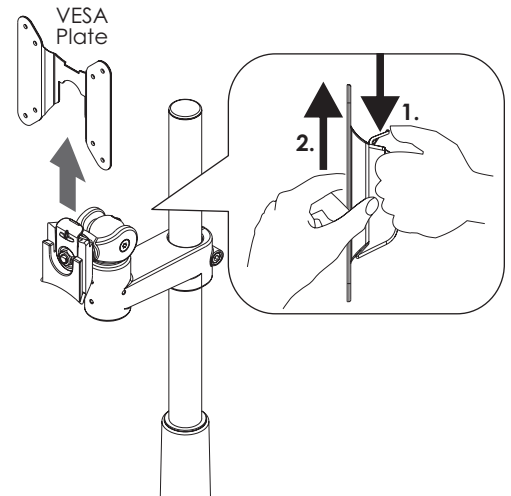

- Place the monitor face down on a flat surface. Align the VESA plate holes with the holes on the back of the monitor. Attach the VESA plate using the four VESA plate screws provided.
 - There are two sets of four holes on the VESA plate. One set has holes 3.9" (100mm) apart, the other set has holes 3" (75mm) apart. Use the set that matches the holes on the monitor.

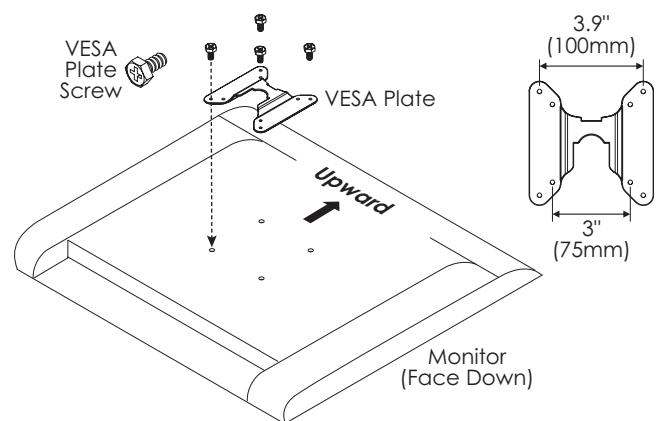

Attach Monitor to Arm Stem Assembly

- Slide the VESA plate (with monitor attached) onto the VESA mount. Make sure the VESA plate clicks securely in place.
- **Optional:** Install a VESA locking screw behind each VESA plate to prevent the tab on the VESA mount from releasing the monitor.

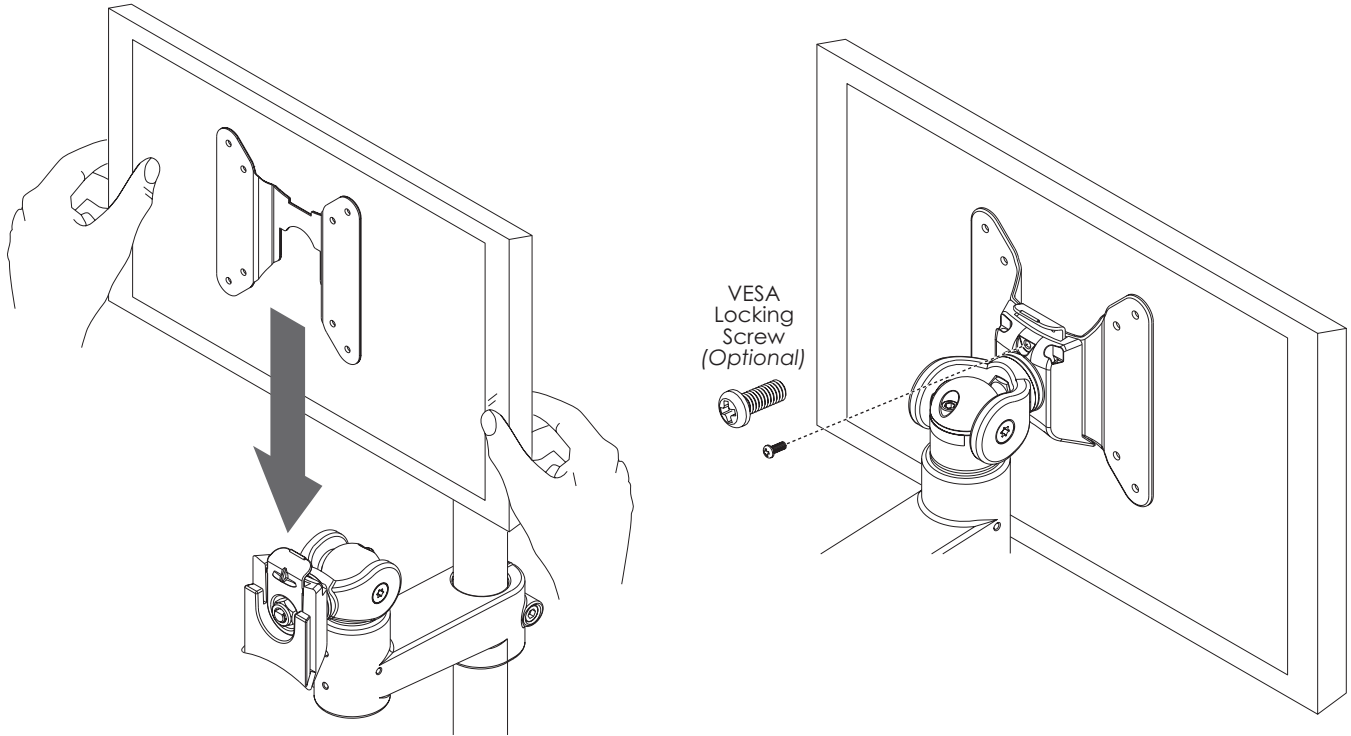

Cable Management

- Use the pole clips to manage and organize the cables running down the pole. Snap the pole clips in position with the cables captured.

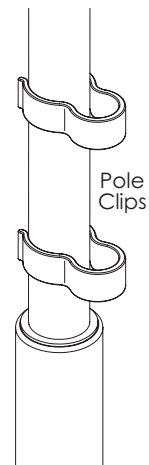

Monitor Tilt Adjustment

- Use the 4mm Allen key to adjust the socket screw for the appropriate monitor weight.
 - Turn the Allen key clockwise for heavier monitor or counterclockwise for lighter monitors.

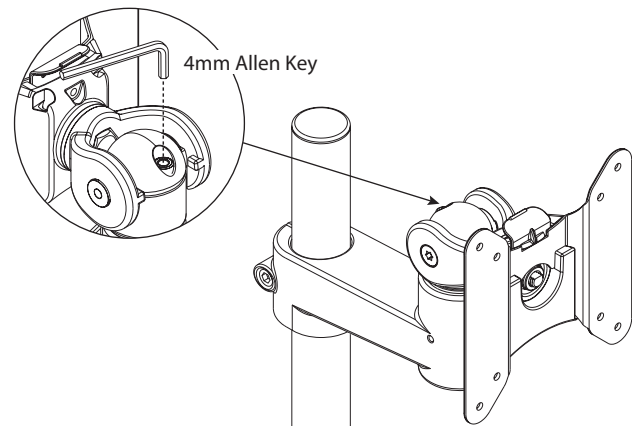

Allen Key Storage

- Insert the Allen keys into the holes behind the VESA plate to store for future adjustment.

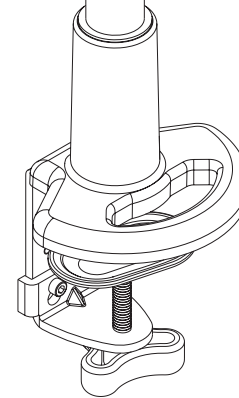
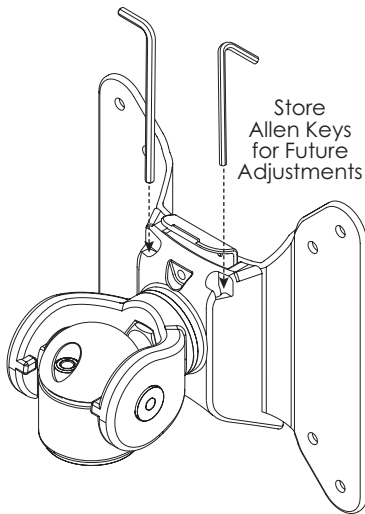



800.833.3746 | esiergo.com