



800.833.3746 | esiergo.com



# Instructions

## KEYBOARD TRACK SPACER KIT

Model SPACERKIT-KBD-V2

SPACERKIT-KBD-V2 Rev B 1/17

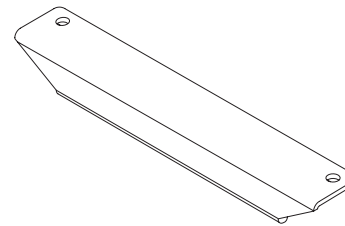

Front Track Bracket (1)

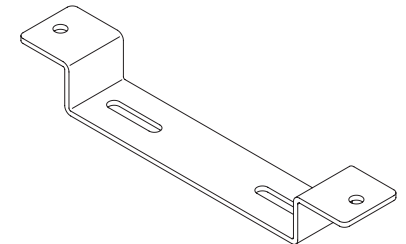

Rear Track Bracket (2)



6mm Spacer (6)



10mm Spacer (6)



20mm Spacer (8)



M5 Serrated  
Flange Nut (8)



M5x25mm (6)

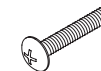

M5x30mm (2)

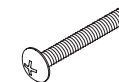

M5x40mm (6)

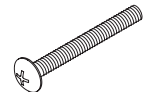

M5x50mm (6)



M6x16mm (6)

## INSTALLATION

## KEYBOARD TRACK SPACER KIT

**PLEASE REVIEW** these instructions before beginning the installation. Check that all the parts shown on the cover were provided with your order. Contact your supplier if any materials are missing. Do not discard the packaging until satisfied that the product operates to your satisfaction.

### Step 1

Determine which spacers and machine screws to assemble.

- Measure the height of the cross channel or other obstruction that needs to be cleared.
- Choose the spacer/screw combination for the proper amount of clearance.

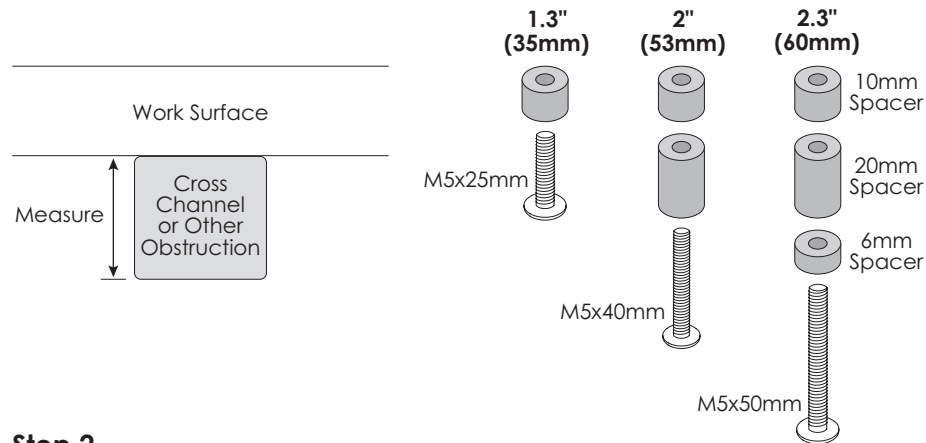

### Step 2

Assemble the spacers and brackets to the keyboard track. See the illustration at the top of the next page.

- In this example, an additional clearance of 2" (53mm) is added.
- Install 20mm spacers at the rear on the track for bumper spacer mounts. Use an M5x30mm screw. Do not install the front bumper until after loading the tray into the track.
- Secure all screws with the M5 serrated flange nuts.

### Step 3

Attach the track/spacer assembly to the underside of the work surface using the six M6x16mm wood screws. See the illustration at the bottom of the next page.

- Attach the wood screws through the mounting holes in the brackets.

**CAUTION:** Always check that screws used to attach components to the work surface are not too long for the thickness of the surface.

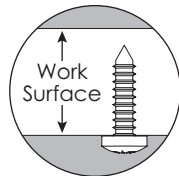

## KEYBOARD TRACK SPACER KIT

### Step 2 Illustration

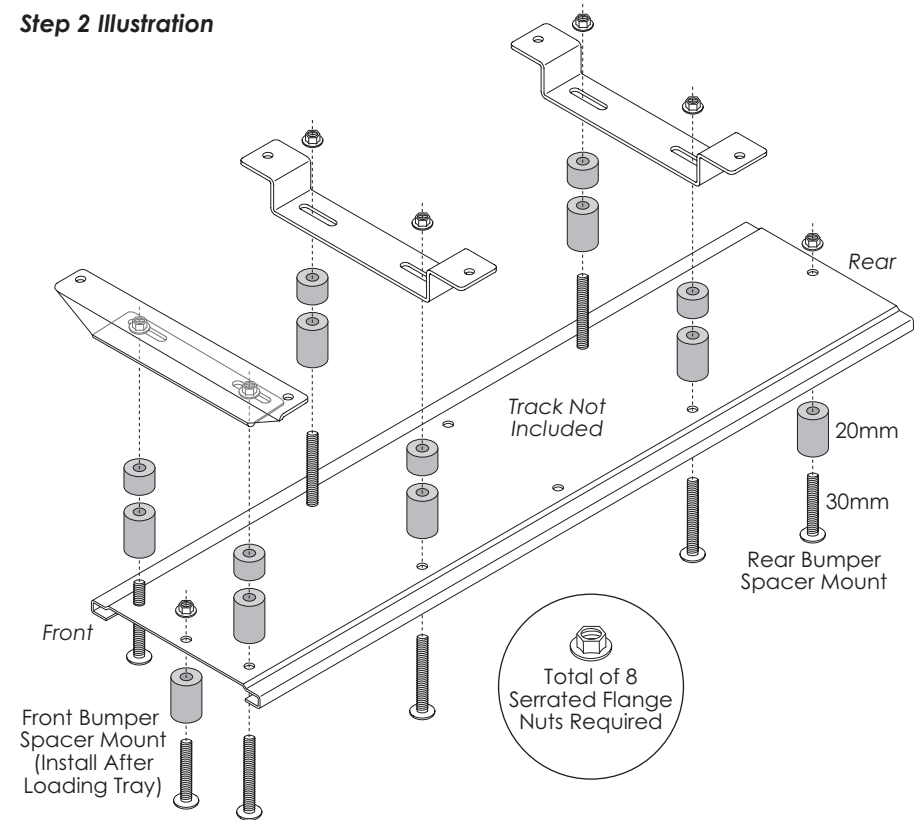

### Step 3 Illustration

