



All-Flex[®] 2-leg + Worksurface

electric table base

All-Flex 2-leg + worksurface

electric table base

Rectangle



Dimensions

36"w x 24"d
48"w x 24"d
60"w x 24"d
36"w x 30"d
48"w x 30"d
60"w x 30"d
72"w x 24"d
72"w x 30"d

Base model

2R3624-__-FLEX2-SLV
2R4824-__-FLEX2-SLV
2R6024-__-FLEX2-SLV
2R3630-__-FLEX2-SLV
2R4830-__-FLEX2-SLV
2R6030-__-FLEX2-SLV
2R7224-__-FLEX2-SLV
2R7230-__-FLEX 2-SLV

Specify laminate code. See laminate guide for details.

Casters model

CASTERKIT-FLEX2

All-Flex features

Top support at 19.3"



Top support at 23.3"



Foot at 28.0"



Foot at 22.0"

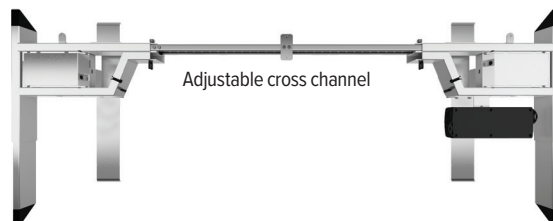

Adjustable cross channel

Product Specs

- One part number for all 2-leg sizes
- Height adjustment range: 26.0"
 - Low: 23.2" | High: 49.2"
 - (excluding worksurface)
- Adjusts to fit worksurfaces 36.0"–84.0" wide
- Adjustment speed: 1.5"/sec
- Base lifting capacity: 265 lbs.
- Adjustable feet: 22.0" or 28.0" long (patented design)
- Crossbar includes guide markings to assist in setting width
- Top support expands to more effectively accommodate worksurfaces 24.0"–36.0" deep
- Notched cross channel offers ample space for keyboard tray glide tracks
- Anti-collision safety feature
- 86" power cable
- Quick start
- Digital keypad with four memory settings
- Folding frame design for quick assembly
- Integrated control unit shelf
- Integrated storage for foot extension plate when not in use
- Integrated cable management
- Quiet adjustment
- Steel construction
- Low power consumption
- Lead free
- Three-stage adjustable legs
- Dual motors
- ADA compliant
- Optional casters are available
- Available on GSA contract
- Warranty All-Flex:
 - 15 yrs. structural | 7 yrs. mechanical

esi

800.833. 3746
esiergo.com

All-Flex 2-leg + worksurface

electric table base

RETRACTED

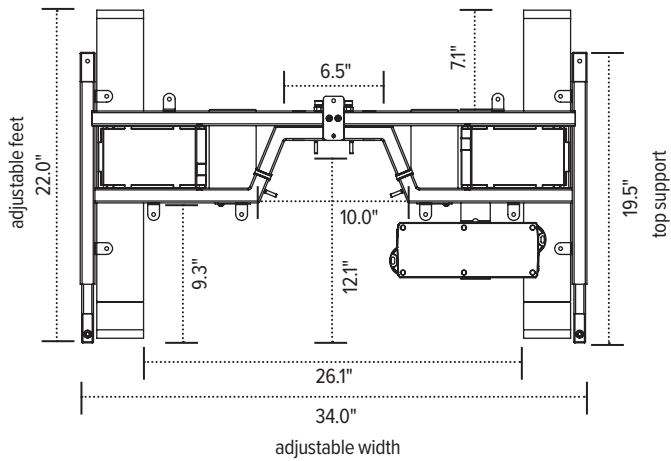

SIDE

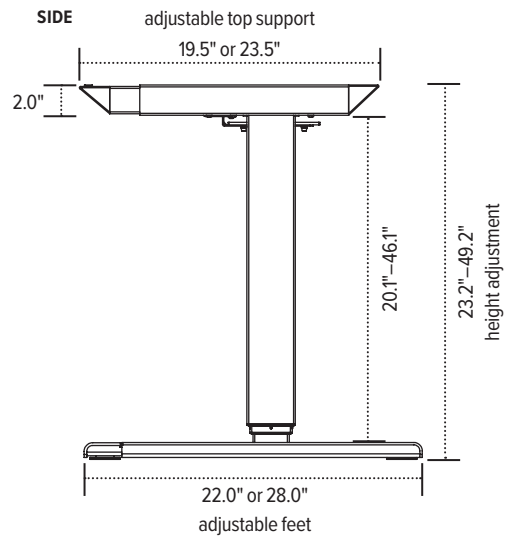

EXPANDED

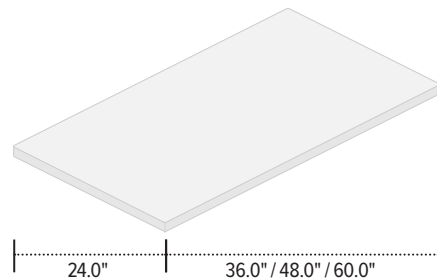
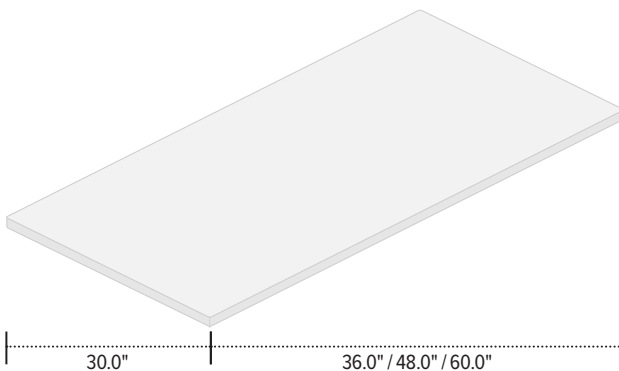
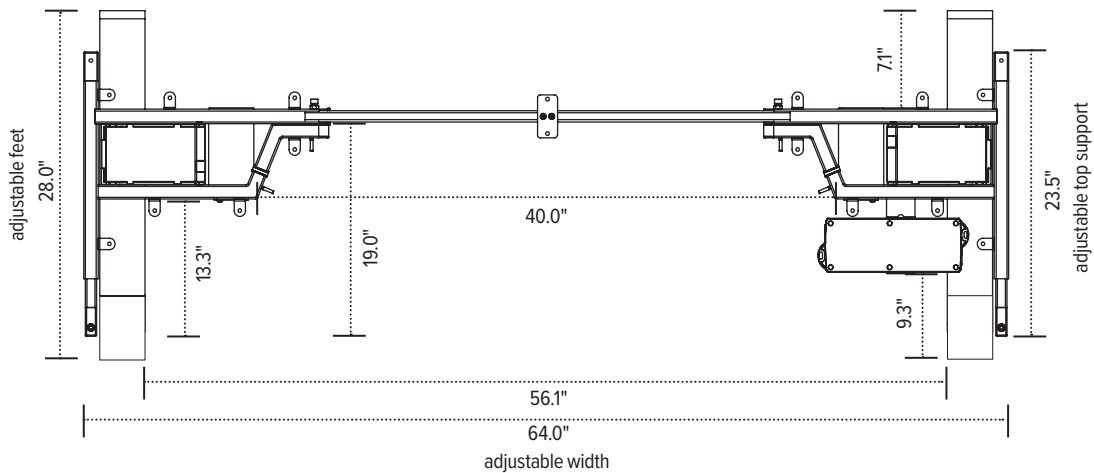

esi

800.833. 3746
esiergo.com