

CPULOCK: Disassembly Instructions

CPULOCK Assembled

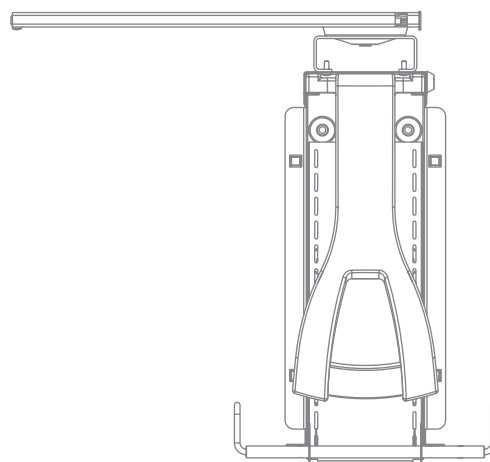
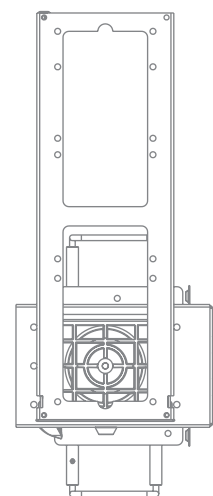
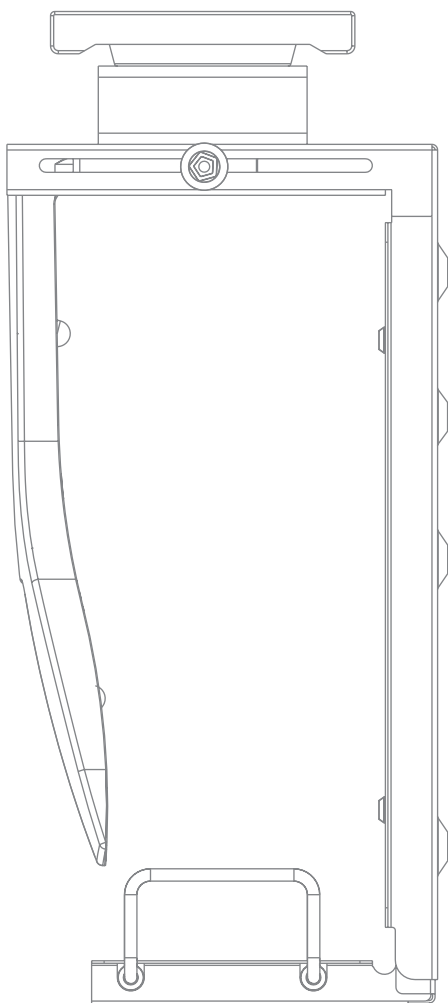

CPULOCK: Disassembly

CPULOCK Components for breakdown

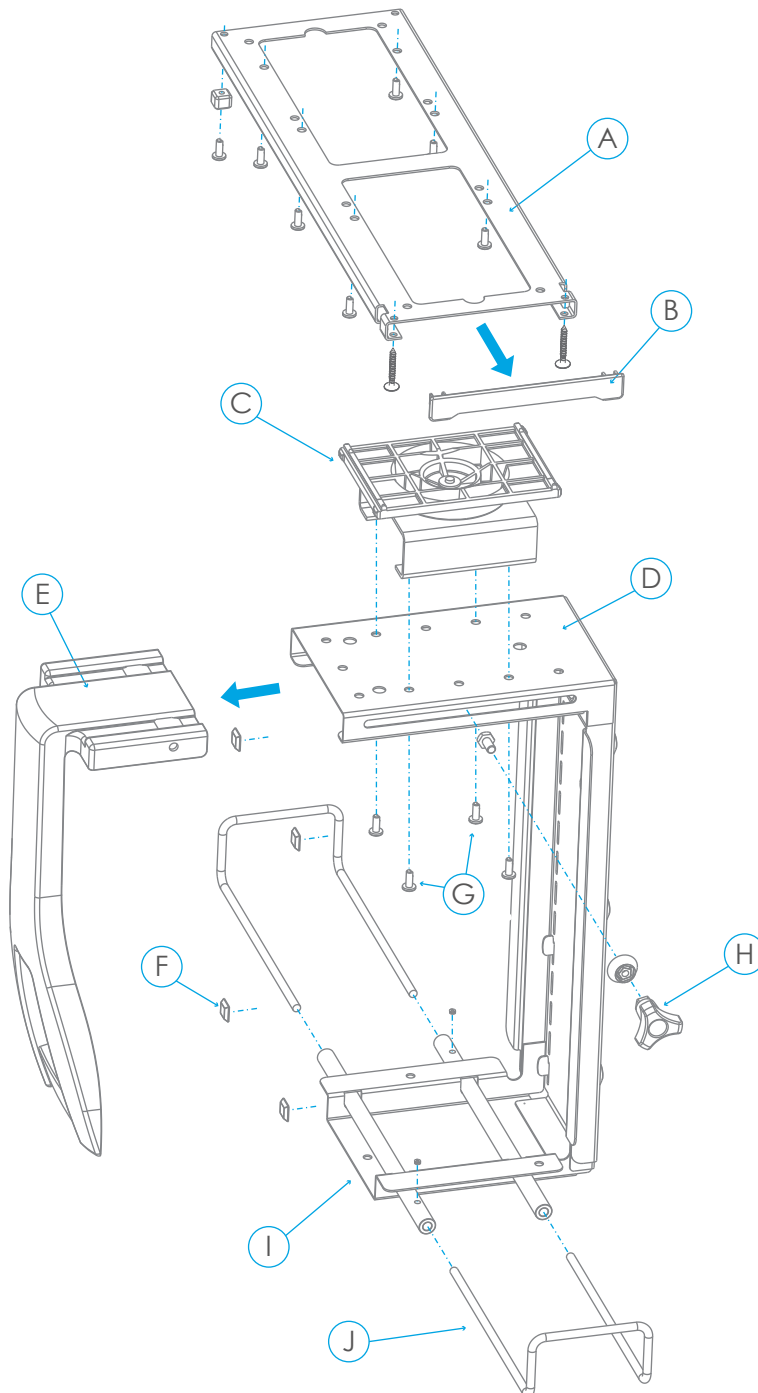

Material Identification

- A: Track
 - Steel ♻️
- B: Front Stopper
 - Plastic
- C: Swivel Plate
 - Plastic/Steel
- D: Main Unit
 - Steel ♻️
- E: Retaining Arm
 - Plastic
- F: Bumpers
 - Rubber
- G: Screws
 - Steel ♻️
- H: Knob
 - Plastic
- I: Support Bracket
 - Steel ♻️
- J: Sliding Rods
 - Steel ♻️

Recommended Tools



Gloves



Goggles



Phillips Screwdriver



2mm Allen Wrench

Note:
Removal of powder coat
required in recycling
process.