

# Benching Solutions

Allsteel® Stride monitor arm benching adapter

# Benching Solutions

Allsteel® Stride monitor arm benching adapter



## Product Specs

- Will accommodate tops from 1.0" to 1.2" in thickness
- Compatible ESI monitor arms:
  - Evolve monitor arms: single, dual and triple configurations only
  - Edge® monitor arms: single configurations only
- Holds up to three monitors
  - 15.4 lbs. per slider mount arm
  - 17.6 lbs. per VESA mount
- Fits easily on standard Edge® or Evolve product nesting on base
- Available on GSA contract
- Warranty: 15 yrs.

## Model #

E-SMT-SLV

esi

800.833.3746  
esiergo.com

# Benching Solutions

Allsteel® Stride monitor arm benching adapter

Side view

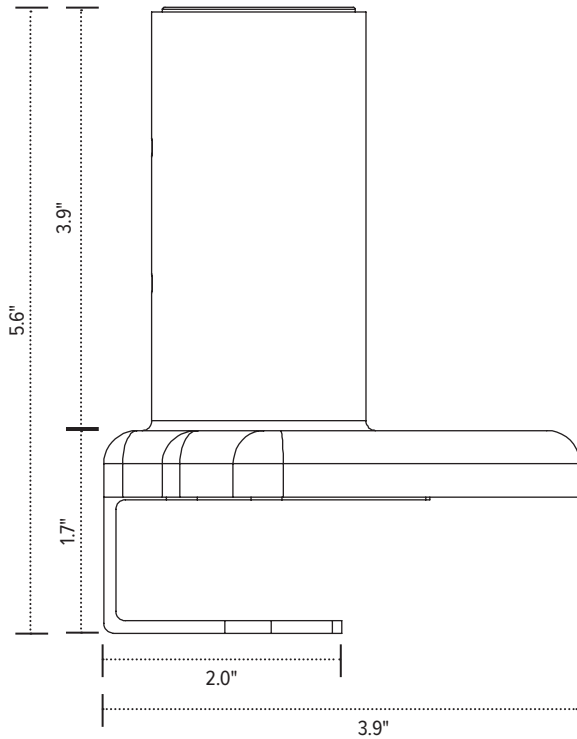

Top view

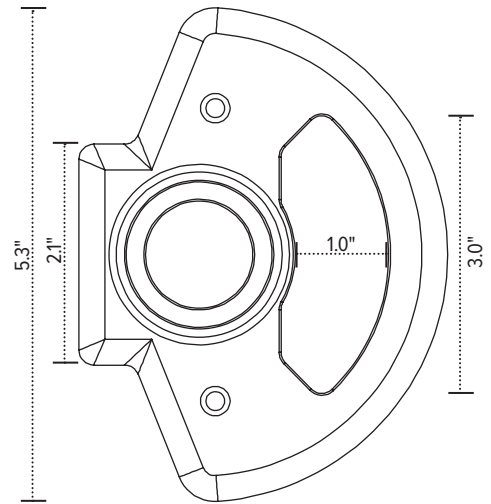

Front view

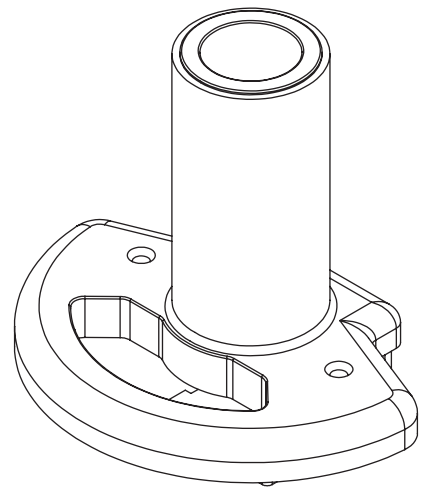
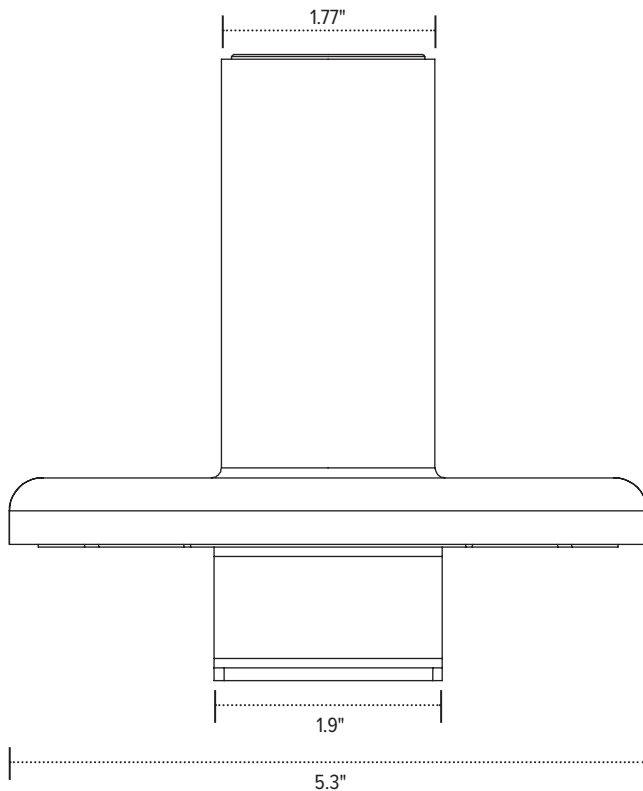

esi

800.833.3746  
esiergo.com