

Eppa2™

dual monitor arm

Eppa2

dual monitor arm



Monitors can pivot from portrait to landscape orientation easily.
Arms have wide range of motion.



VESA mounts tilt up and down, providing a flat writing surface for touch screen monitors



Clip-on tool storage

Product Specs

- Dynamic height adjustment
- Height adjustment range: 11.0"
- Monitor arm extension: 20.8"
- Monitor arm retraction: 4.0"
- Monitor vertical tilt: $\pm 90^\circ$
- Monitor horizontal rotation: $\pm 90^\circ$
- Monitor swivel stop: $\pm 90^\circ$
- Weight capacity: 2.2 lbs.–17.6 lbs. (per arm)
- Fixed and motion arms included
- Capable to swivel between portrait and landscape orientation
- Exceeds BIFMA x5.5 requirements
- Gas spring - finger touch adjustment
- VESA quick mount
- Aluminum and steel design
- Supports two monitors up to 28.0" wide
- Partially assembled for quick installation
- Desk clamp and grommet mount included
- Integrated cord management
- Grommet hole integrated in base to easily route cables
- Clip-on tool holder attaches to base bracket keeping hex keys accessible
- Warranty: 10 yrs.
- Not available on GSA contract 

Model

● EPPA2-SLV

esi

800.833. 3746
esiergo.com

Eppa2

dual monitor arm

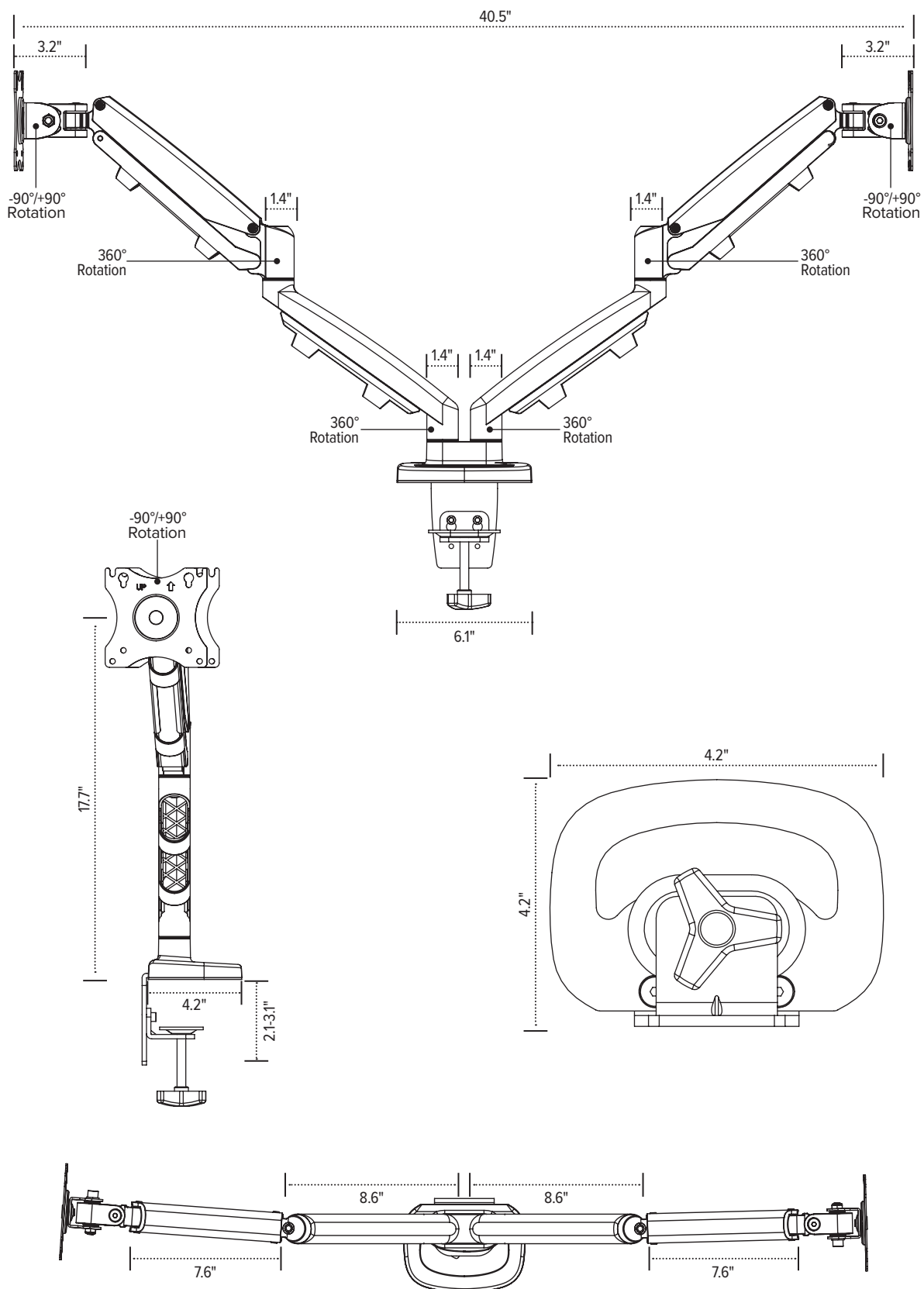

esi

800.833. 3746
esiergo.com

© 2018 Fellowes, Inc.